

FANTIC FMOTOR

2/1988

+ 1987

TRIAL

IKKEI NORGE

303-243-125

serie 1 - serie 2

HVIT RØD/BLÅ

HVIT GUL/BLÅ

catalogo parti di ricambio



FABBRICA MOTOVEICOLI S.P.A.

FANTIC FMOTOR

22061 BARZAGO (Como) Italy - Via Parini 3 - Tel. (031) 860281 - Telefax (031) 860610 - Telex 380448 FANTIC I

A3

USO DEL CATALOGO RICERCA DI UN PARTICOLARE

Esempio: ricerca del numero di codice dell'imbiellaggio di un veicolo con numero di telaio 17002042.

- 1) Cercare nell'indice grafico generale (Tavole A6-A7-A8) la tavola riportante il particolare interessato e rilevare la lettera ed il numero che la contraddistinguono.
- 2) Inquadrare la tavola intestata con la lettera ed il numero rilevato.
- 3) Verificare tramite l'indice di modifica se la tavola ha subito degli aggiornamenti.
- 4) Definire in base al numero di telaio del veicolo che necessita del ricambio se il particolare deve essere ricercato sulla tavola base o sull'aggiornamento.

Nel caso preso come esempio avendo un telaio numero 17002012 il codice del particolare dovrà essere rilevato dalla Tavola E10 in quanto questa vale dal veicolo con numero di telaio n. 17002012.

- 5) Rilevare il numero del particolare tenendo conto degli eventuali simboli che ne specificano norme e validità.

A7

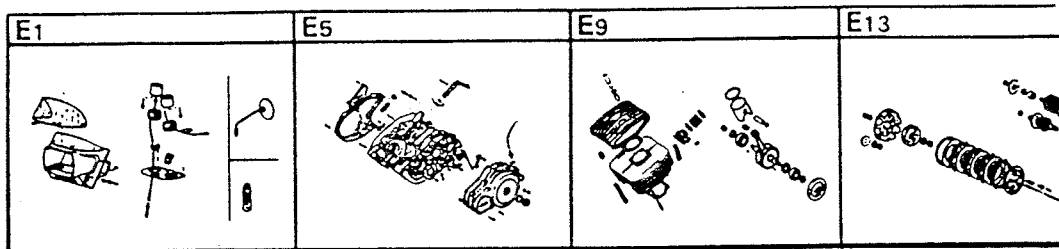

E9

E10		
6-1983		

17001001 →

- 1) Intestazione
- 2) Indice di modifica
- 3) Data di emissione
- 4) La tavola vale dal veicolo con numero di telaio 17001001

- B-C-D-E 400.47.00.5200
- D 400.47.00.5600
- E 250.47.00.5650
- F 155.42.00.5600
- G 400.42.00.5300
- H 400.41.00.5411
- I 400.42.00.5000
- J 400.41.00.5510
- K 400.48.00.5050
- L 450.48.00.5060
- M 155.45.00.5510
- N 250.44.00.5150

E10

E10		
6-1983		

17002012 →

- A 160.10.00.6570
- B 250.48.00.5100
- C 400.47.00.5990
- D 250.47.00.5755 - f 0.5
- E 260.47.00.5801
- F 400.45.00.5500
- G 450.41.00.5500
- H 250.47.00.5400
- I B-C-D-E 400.47.00.5200
- J 400.47.00.5600
- K 250.47.00.5650
- L 155.42.00.5600
- M 400.42.00.5300
- N 400.41.01.5410
- O 400.42.01.5000
- P 400.41.01.5400
- Q 400.48.00.5050
- R 450.48.00.5060
- S 155.45.00.5510

A4

INTERPRETAZIONE DEI SIMBOLI E DELLE ESPRESSIONI CODIFICATE ADOTTATE

★400.01.00.5001

A+B+... N.

190.01.00.5200

191.01.00.5200

322.47.00.5210+2/10

155.43.00.8030 ≠ 0,4

310.15.00.5140 d.

310.15.00.5150 s.

~~191.01.00.5200~~

Z=...

N. ...

SG

SP

1

2

3

4

5

6

SD

M 6x16

M 6

Ø 6x18

- = Particolare modificato o aggiunto rispetto alla tavola precedente
- = Confezione ricambi composta dai particolari A + B + ... illustrati nella tavola
- = In alternativa
- = Particolare con indicazione della maggiorazione di 2/10
- = Particolare con indicazione dello spessore di 0,4 mm.
- = Particolare destro } rispetto al senso di marcia
- = Particolare sinistro }
- = Parte sostituita o eliminata
- = Numero dei denti
- = Dopo esaurimento fornire N. ...
- = Serie guarnizioni completa
- = Serie premistoppa motore completa
- = 1ª velocità
- = 2ª velocità
- = 3ª velocità
- = 4ª velocità
- = 5ª velocità
- = 6ª velocità
- = Serie decalcomanie veicolo completa
- = Diametro e lunghezza delle viti di uso comune non fornite come ricambio
- = Diametro dei dadi di uso comune forniti come ricambio
- = Diametro interno (6) e diametro esterno (18) delle rondelle di uso comune non fornite come ricambio

A5

INTERPRETAZIONE DEI SIMBOLI E DELLE ESPRESSIONI CODIFICATE ADOTTATE

287.07.00.5000

BI = Particolare con indicazione del colore veicolo

BI = Bianco

CA = Champagne

GI = Giallo

RO = Rosso

VE = Verde

NE = Nero

BL = Blu

MA = Marrone

AZ = Azzurro

AR = Arancione

GR = Grigio

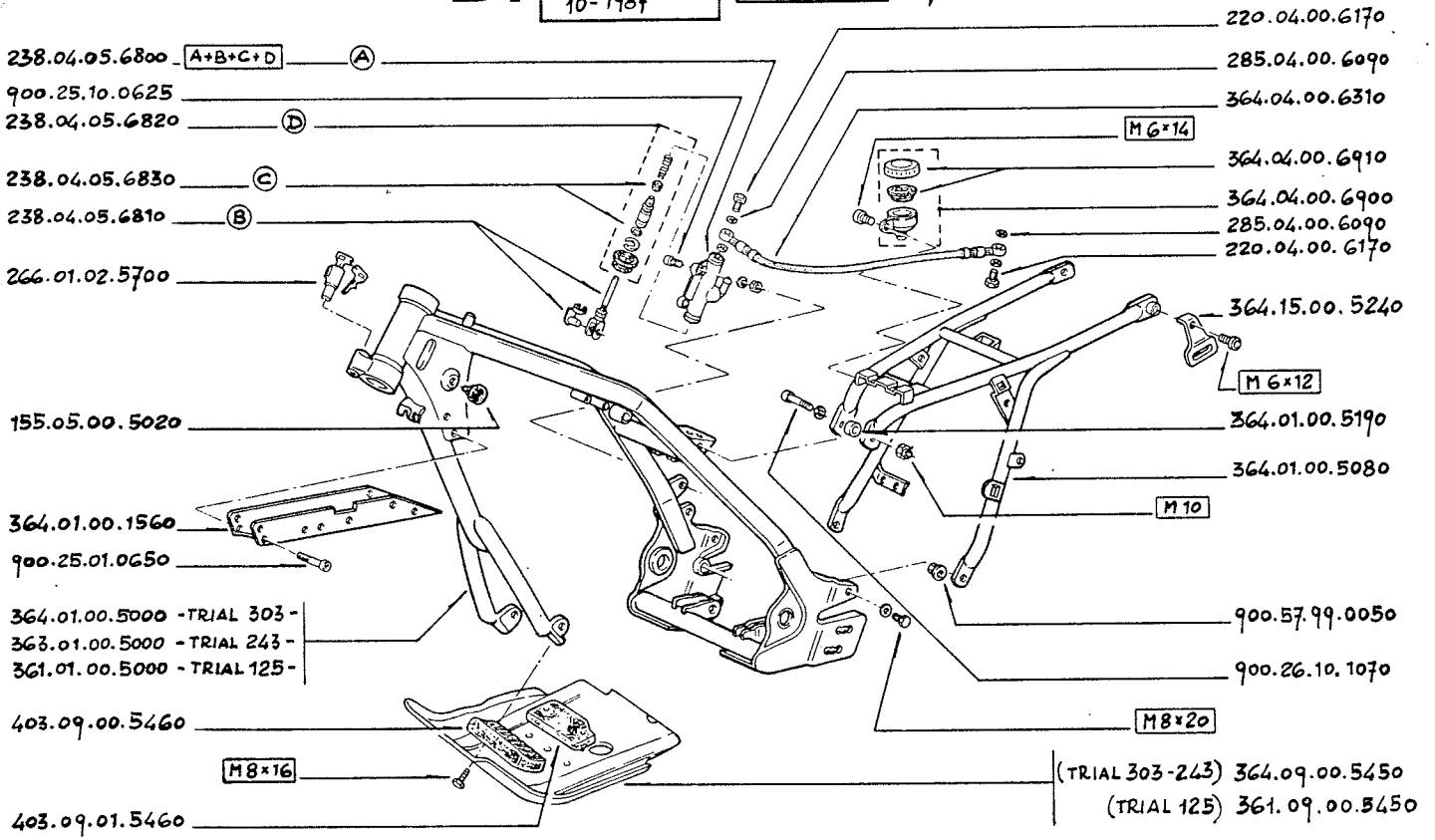
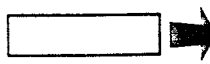
B1B2
10-1987**serie 2****B2**

10-1987

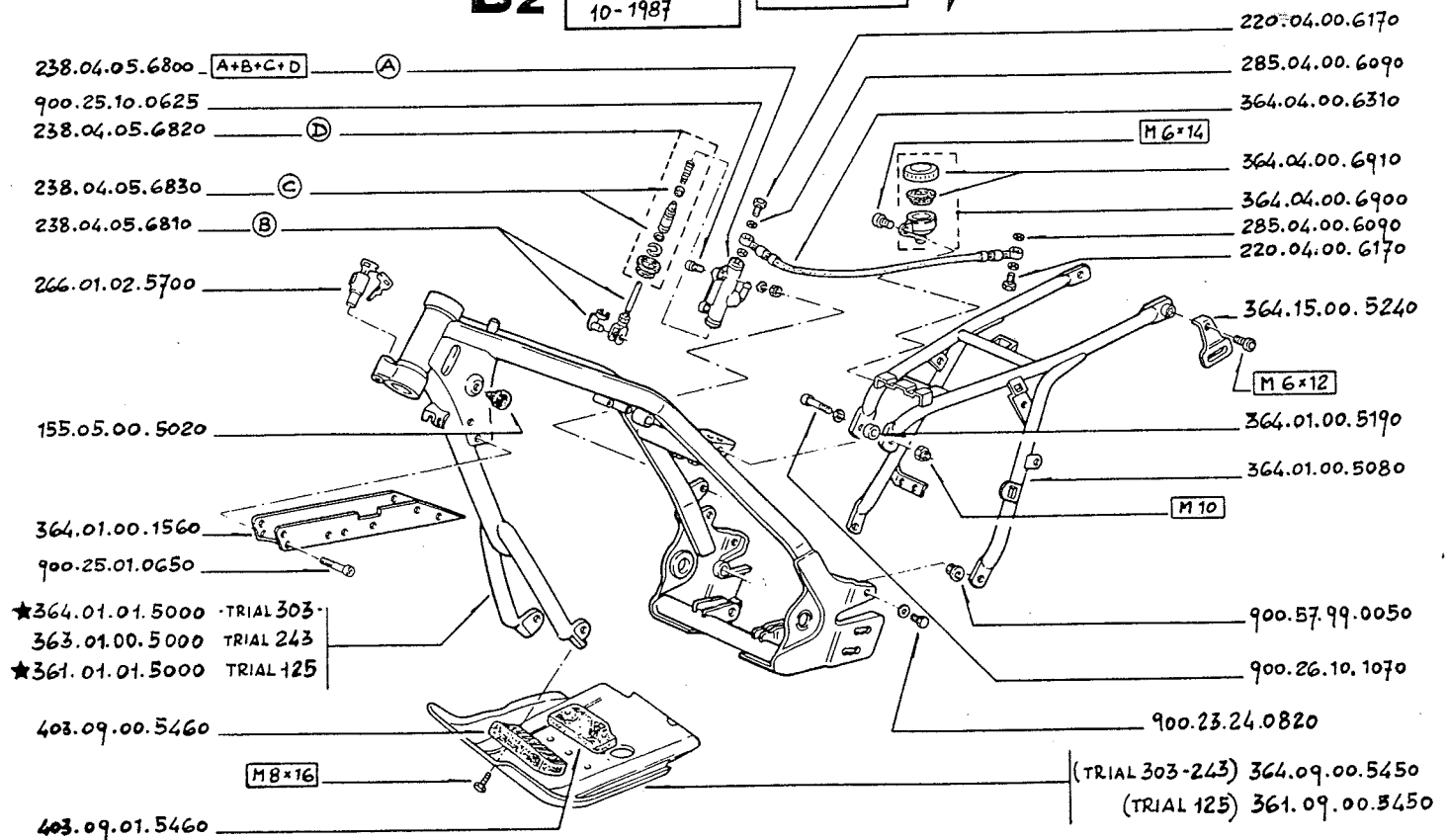
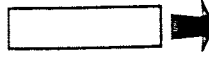

B5

10-1987		

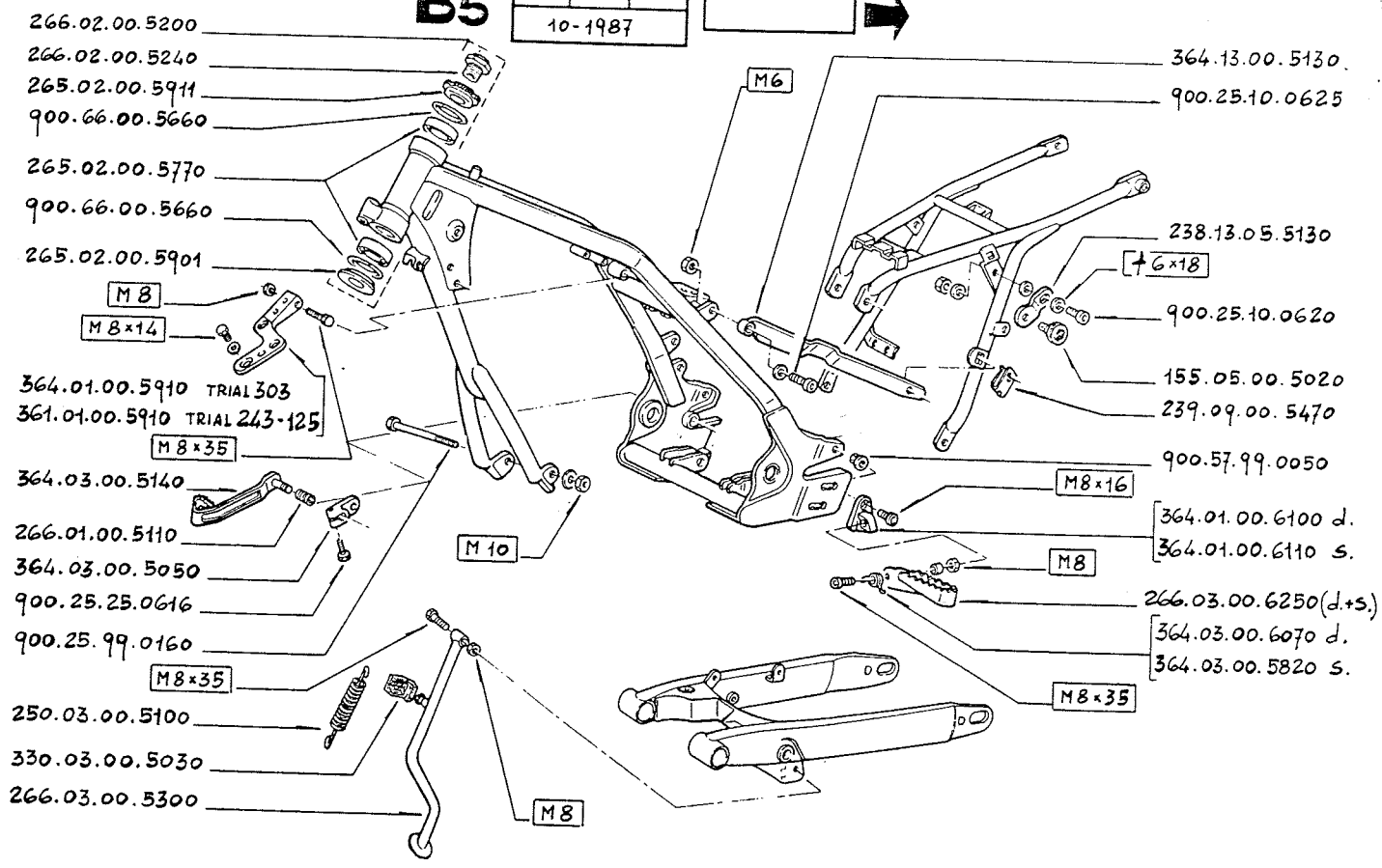
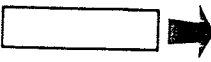

B9

B10	B11
10-1987	

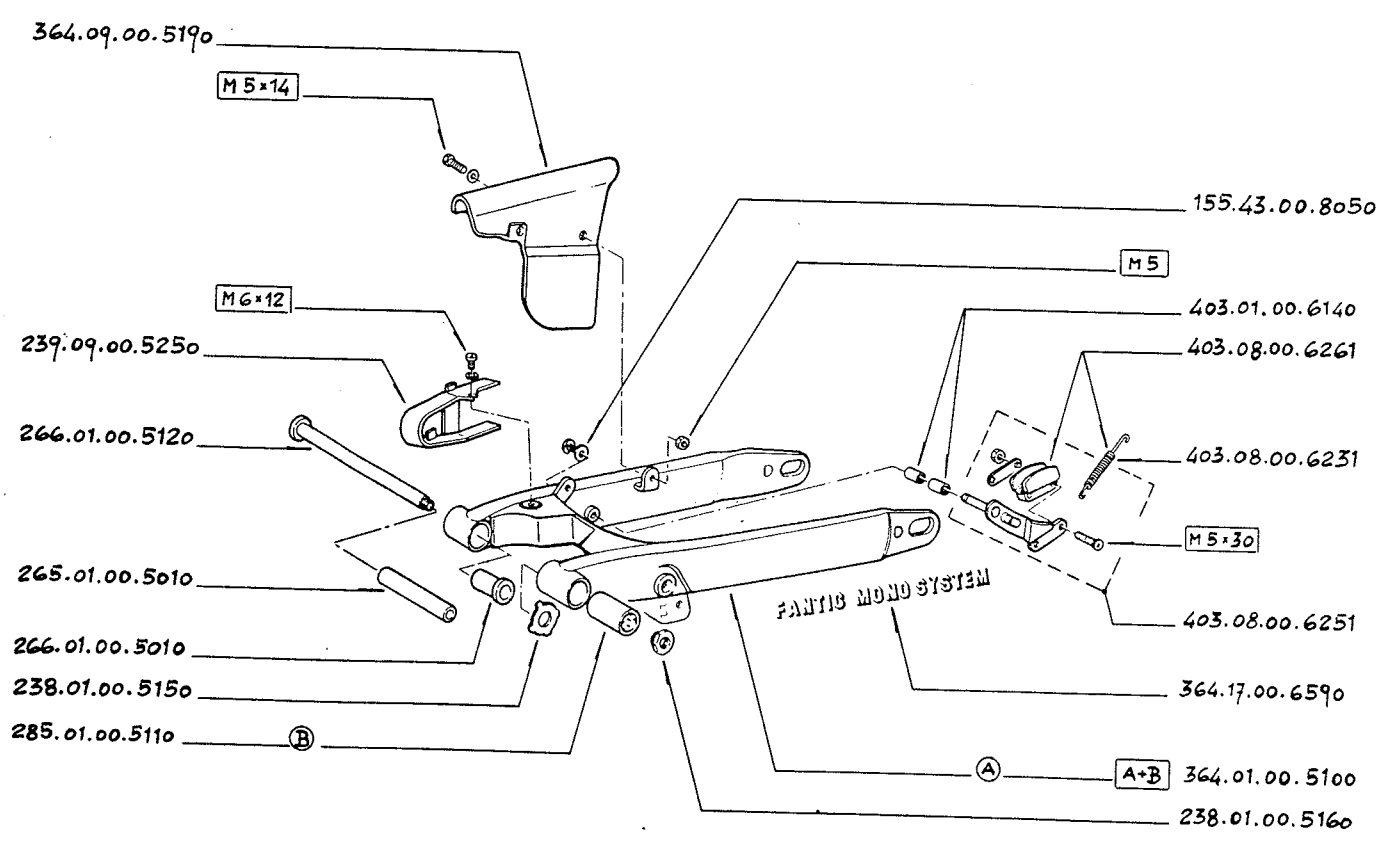
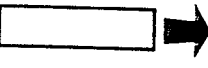

serie 2
TRIAL 303-125

B10

B11		
10-1987		

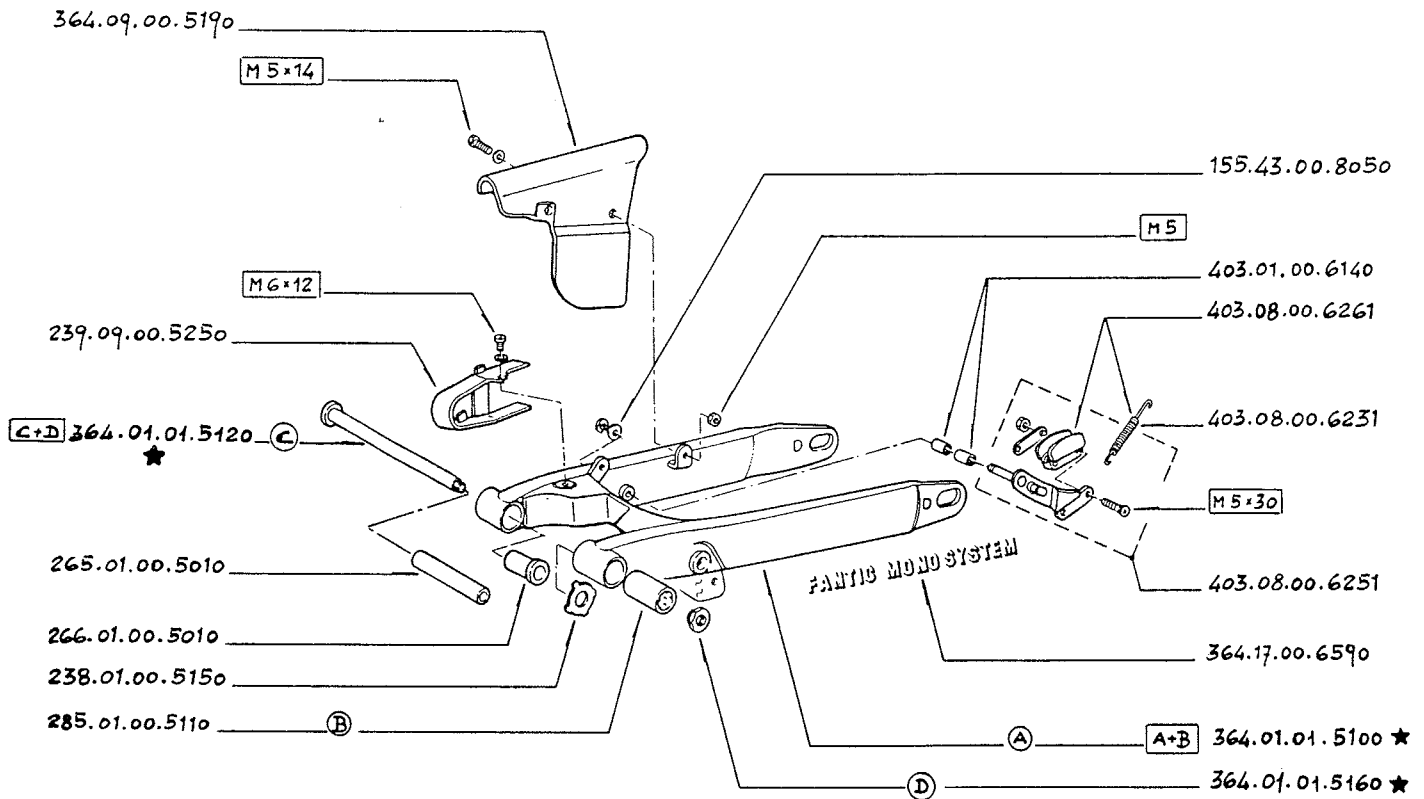
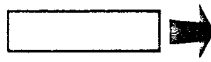

serie 2
TRIAL 243

B11

10-1987		

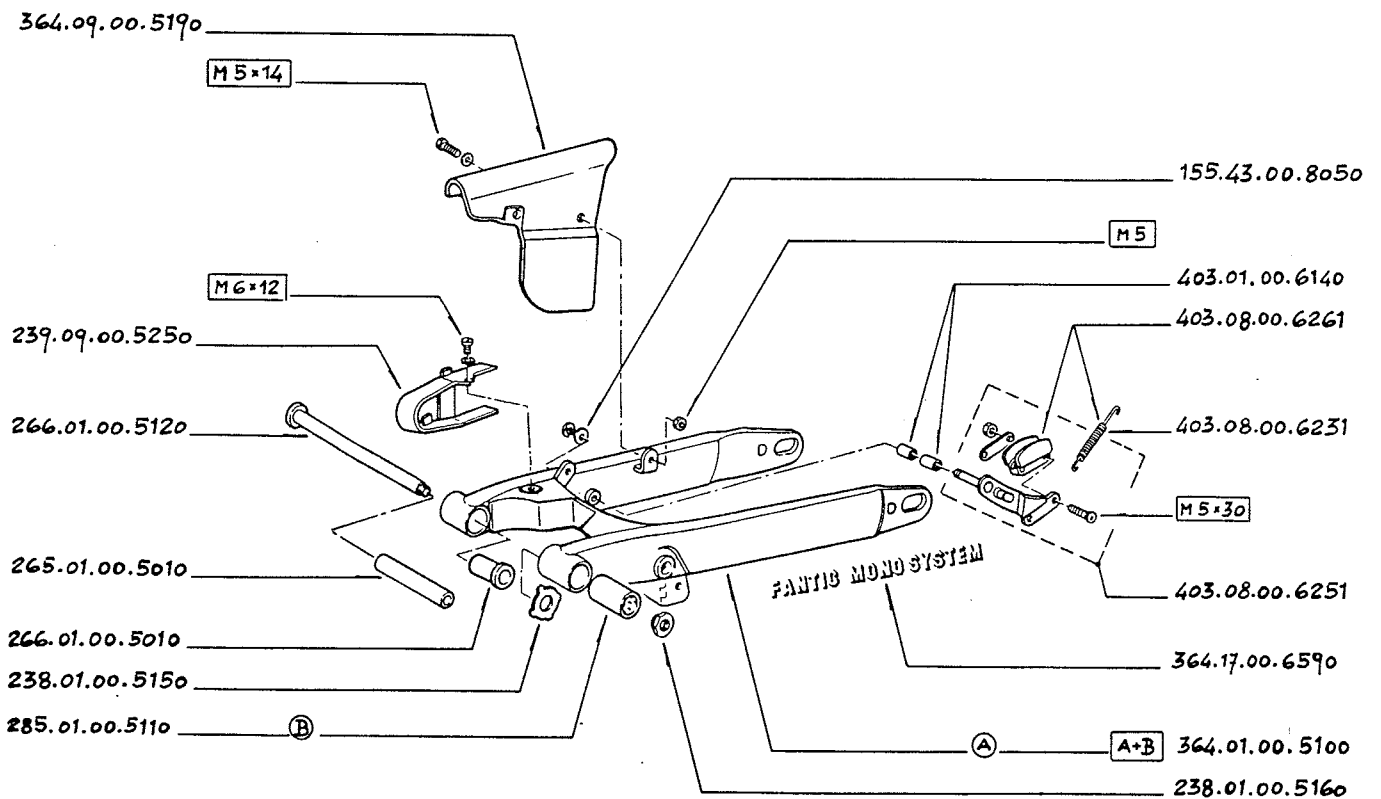
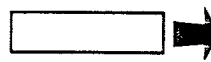

B13

B14
10-1987

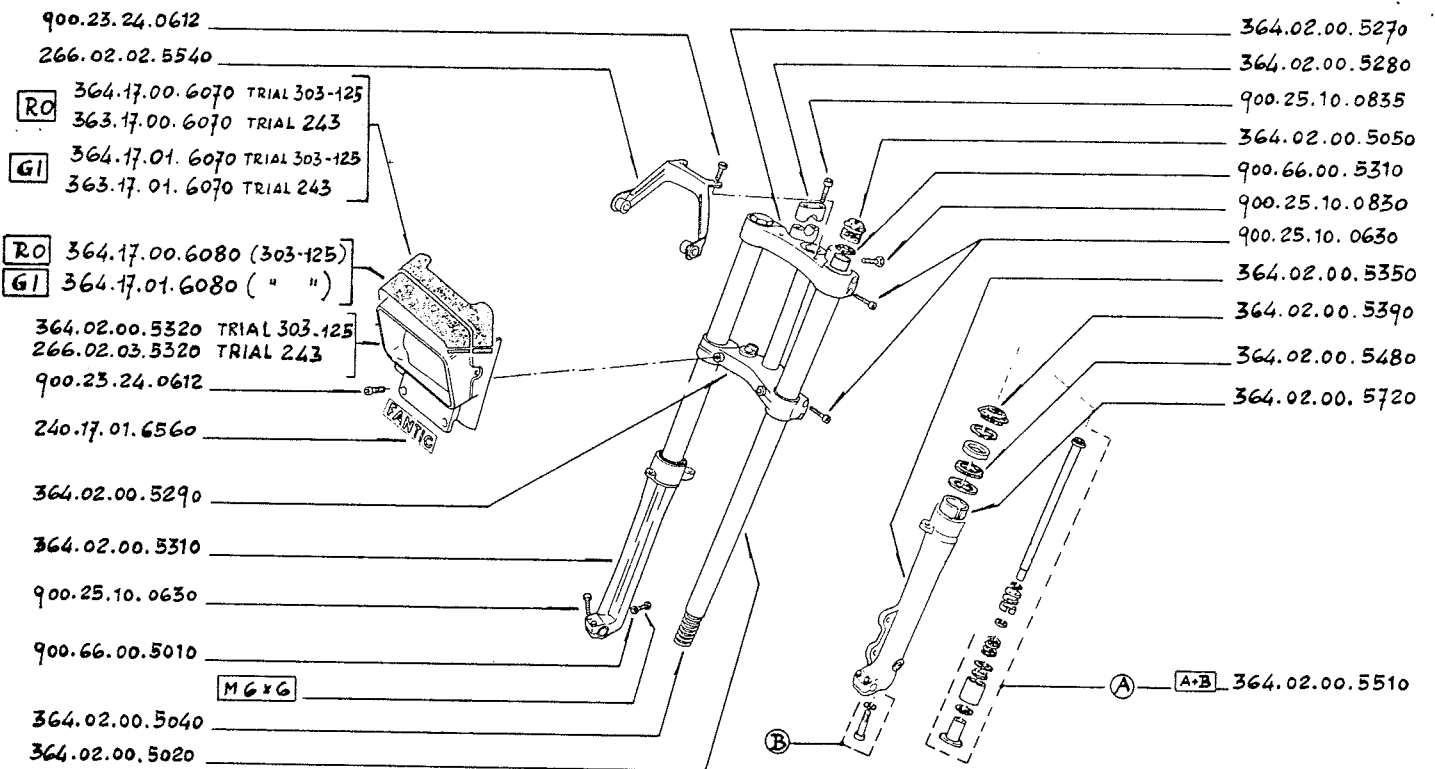
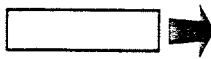

- | | | | |
|-------------------------------------|--------------------------|--------------------|------------------------------|
| 364.02.00.5000 - Forcella ant. cpl. | - Fourche avant complète | - Fork complet | - Vordere Radgabel Komplett |
| 364.02.00.5810 - Gamba dx. cpl. | - Jambe droite complète | - Leg complete R/H | - Rechtes Gabelbein Komplett |
| 364.02.00.5800 - Gamba sx. cpl. | - Jambe gauche complète | - Leg complete L/H | - Linkes Gabelbein Komplett |

serie 2

B14

10-1987

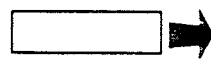

Forcella tipo_Fork type M1

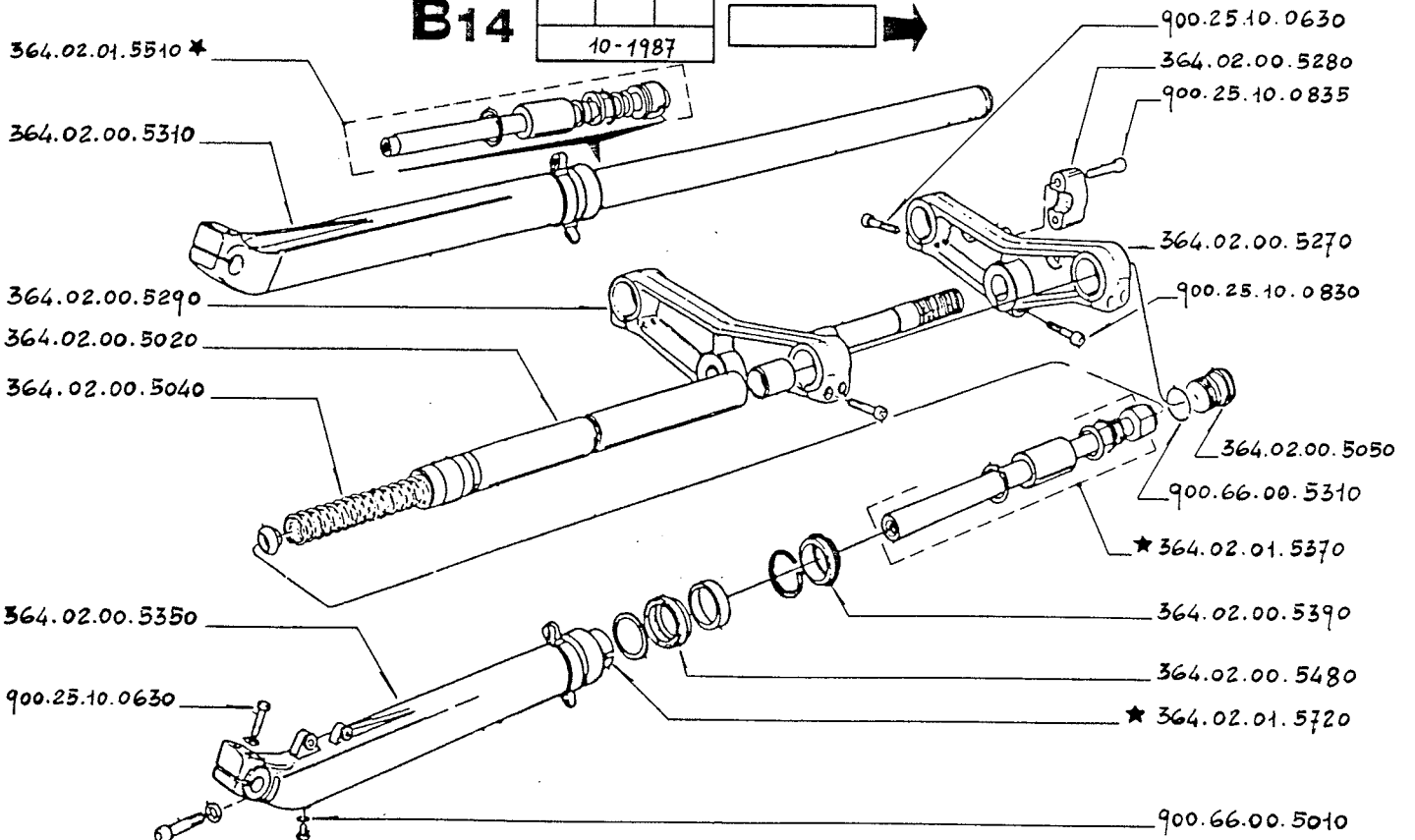

- | | | | |
|-------------------------------------|--------------------------|--------------------|------------------------------|
| ★ 364.02.01.5000 Forcella ant. cpl. | - Fourche avant complète | -- Fork complet | - Vordere Radgabel Komplett |
| ★ 364.02.01.5810 Gamba dx. cpl. | - Jambe droite complète | - Leg complete R/H | - Rechtes Gabelbein Komplett |
| ★ 364.02.01.5800 Gamba sx. cpl. | - Jambe gauche complète | - Leg complete L/H | - Linkes Gabelbein Komplett |

C1

C2	C3
10-1987	

➔

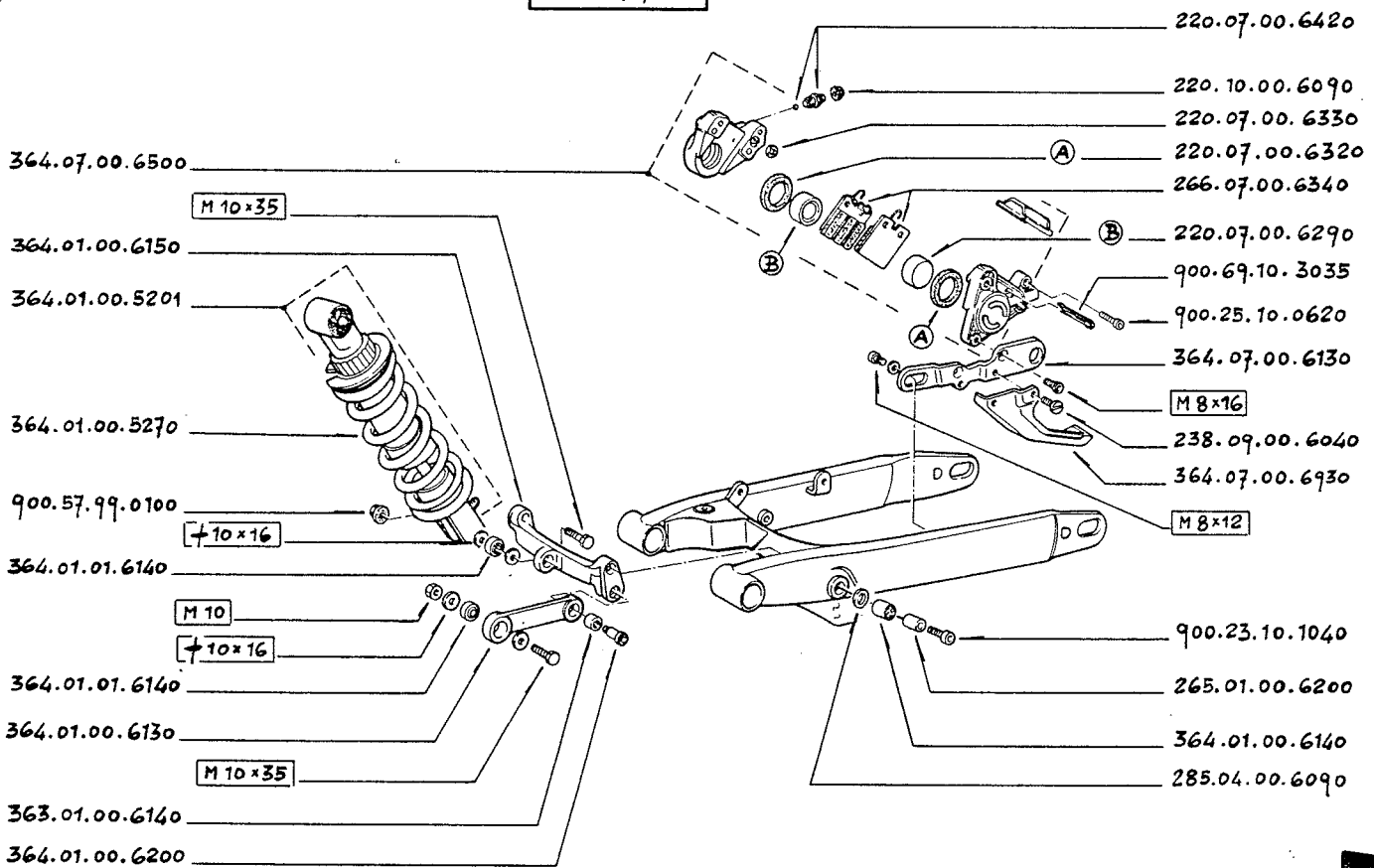

serie 2
TRIAL 303-125

C2

C3	
10-1987	

➔

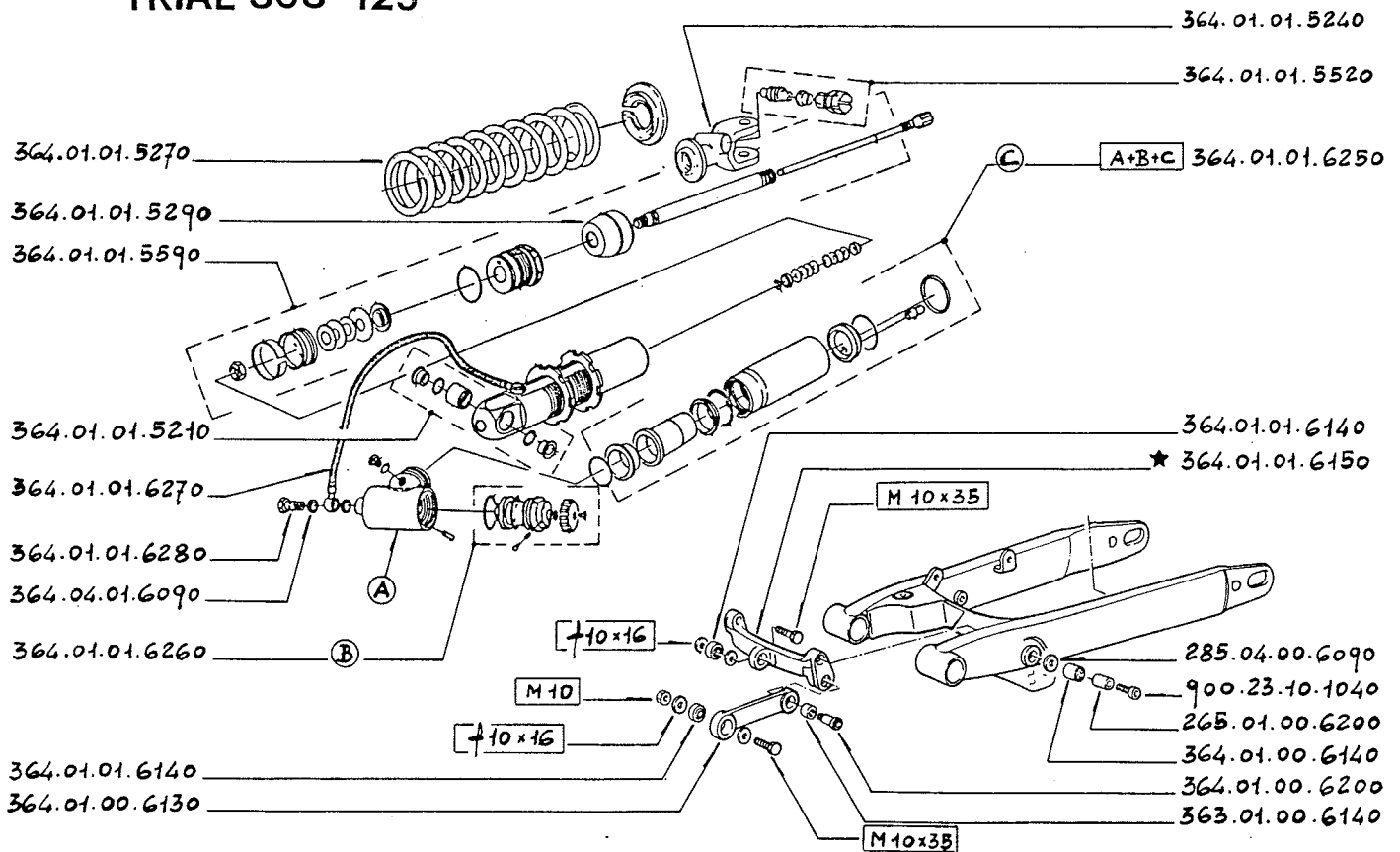

* 364.01.01.5200 Ammortizzatore cpl. - Amortisseur complet - Rear shock absorber complet
- Hinterer Stossdämpfer komplett

serie 2

TRIAL 243

C3

10-1987

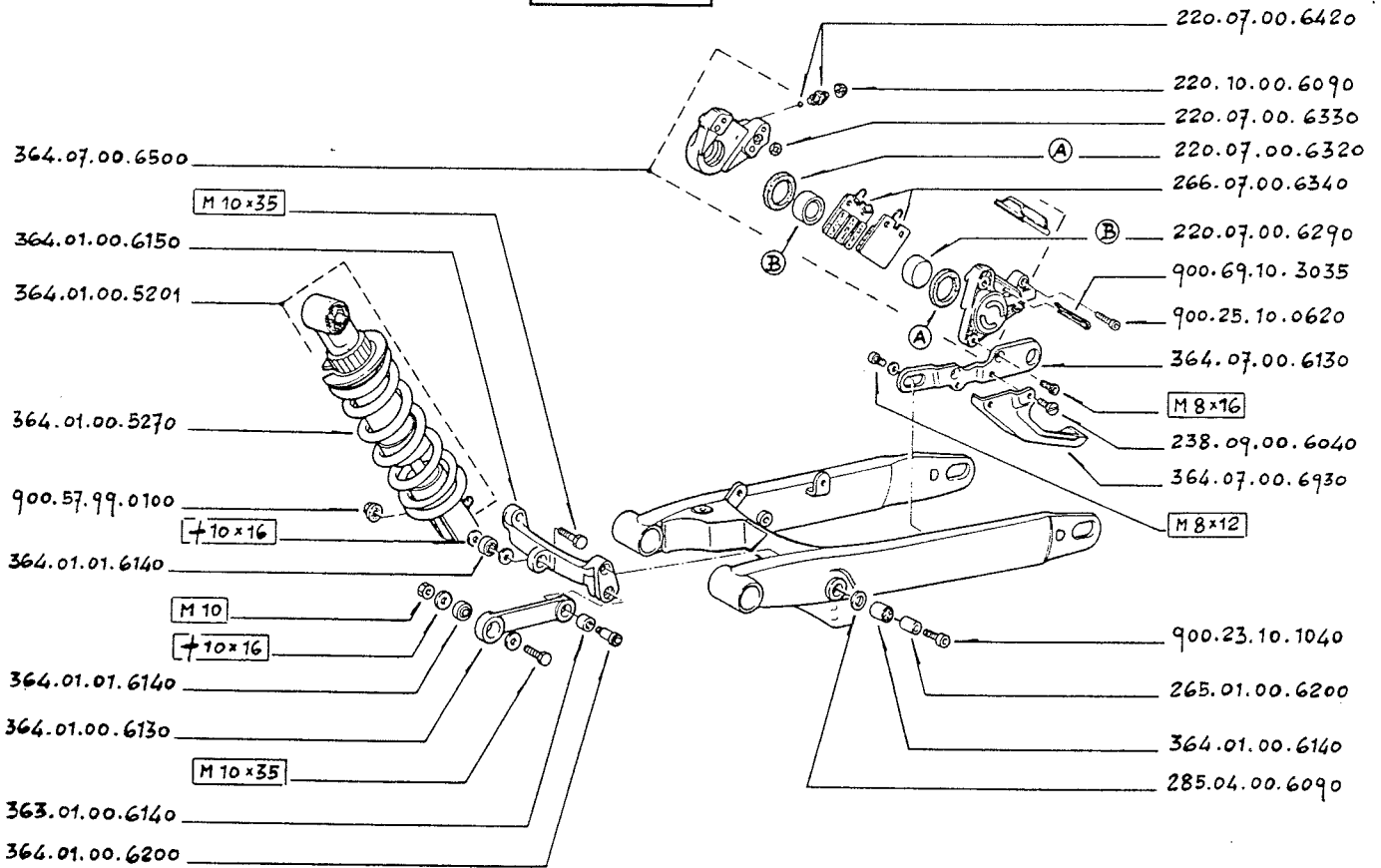
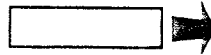

C5

10-1987

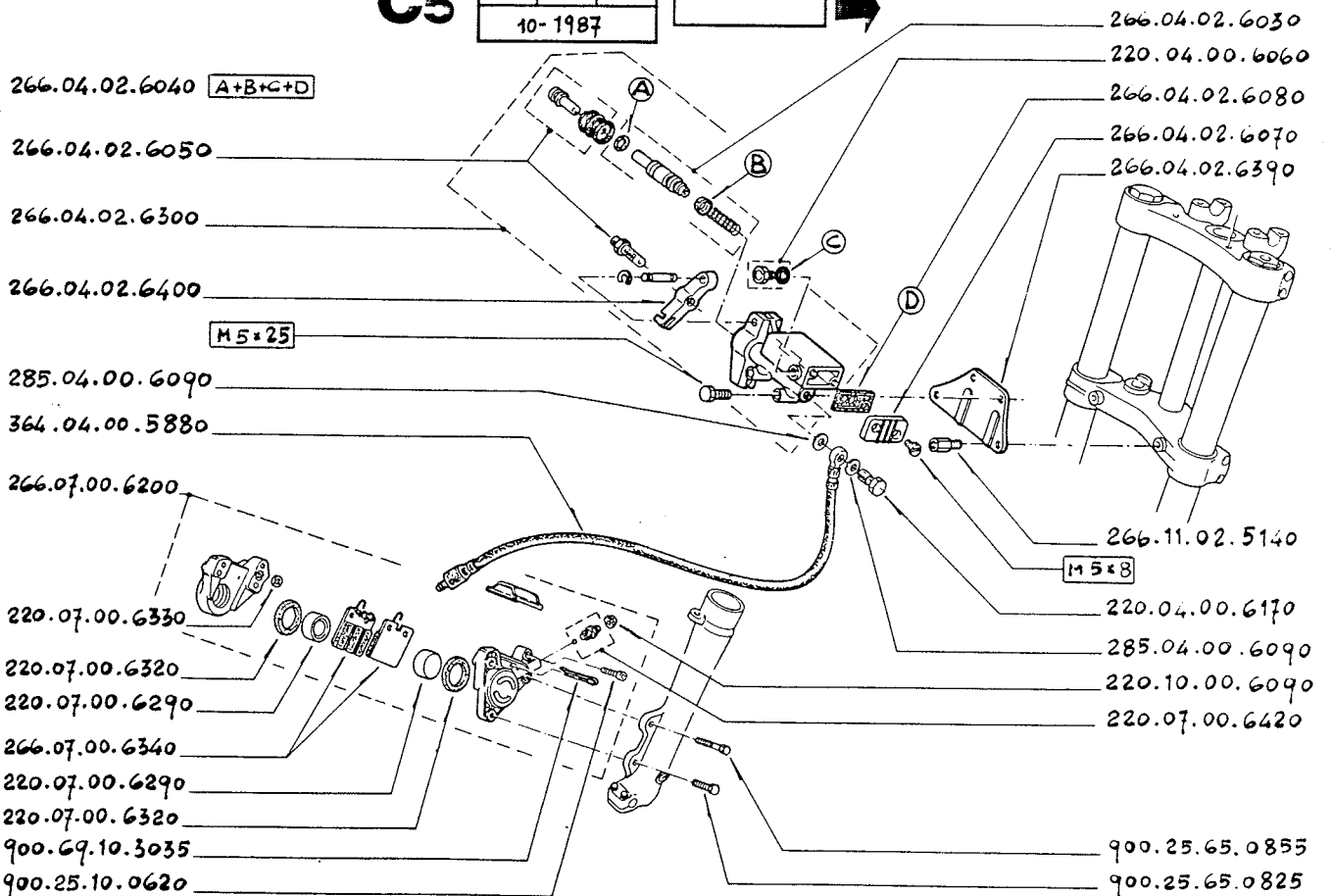
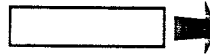

C9

C10

10-1987

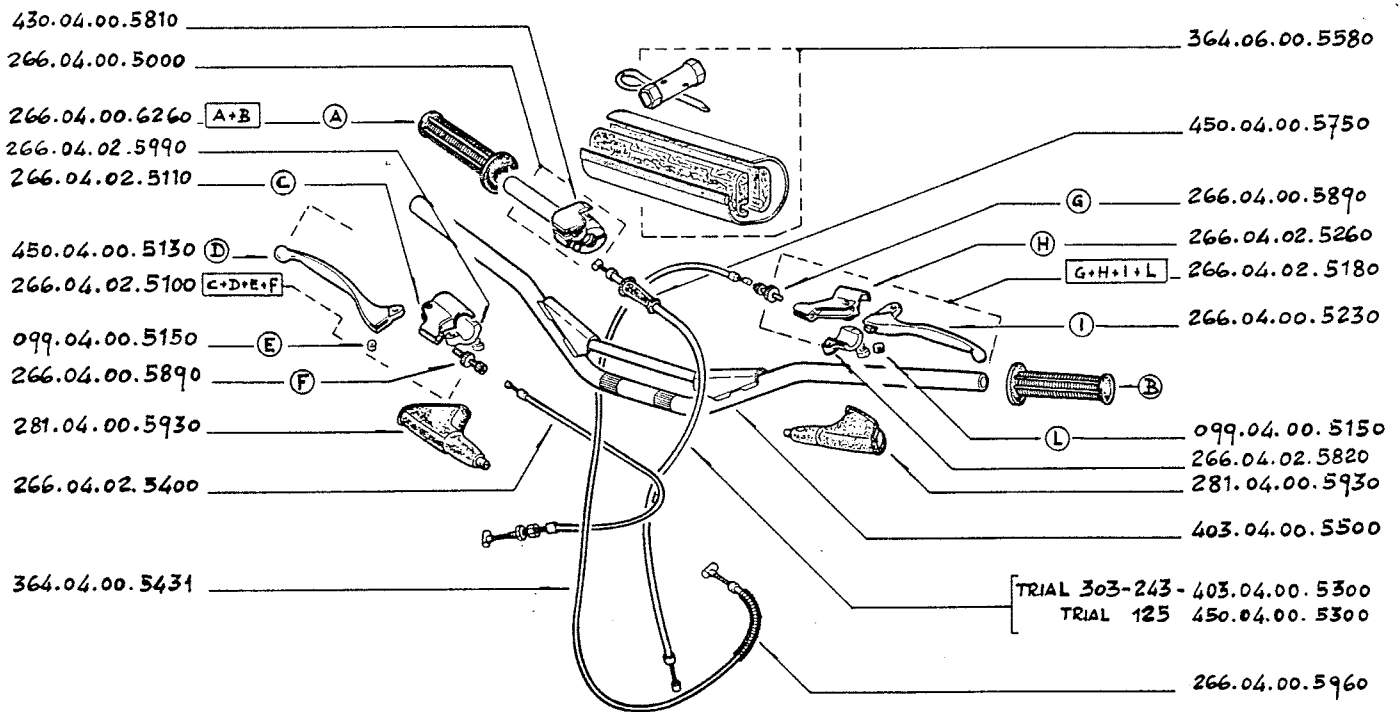
**serie 2****C10**

10-1987

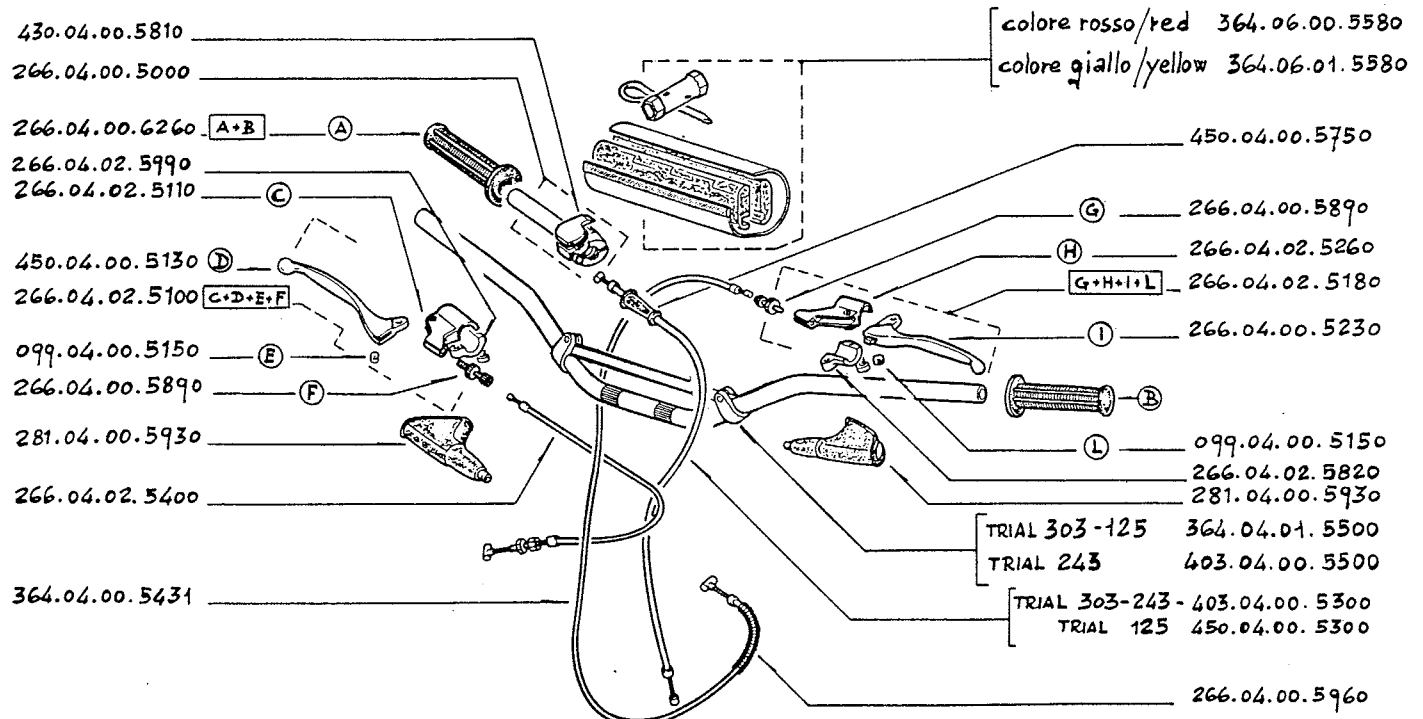

TRIAL 303

C13

C-14		
10-1987		

colore ROSSO/BLU
color RED/BLUE

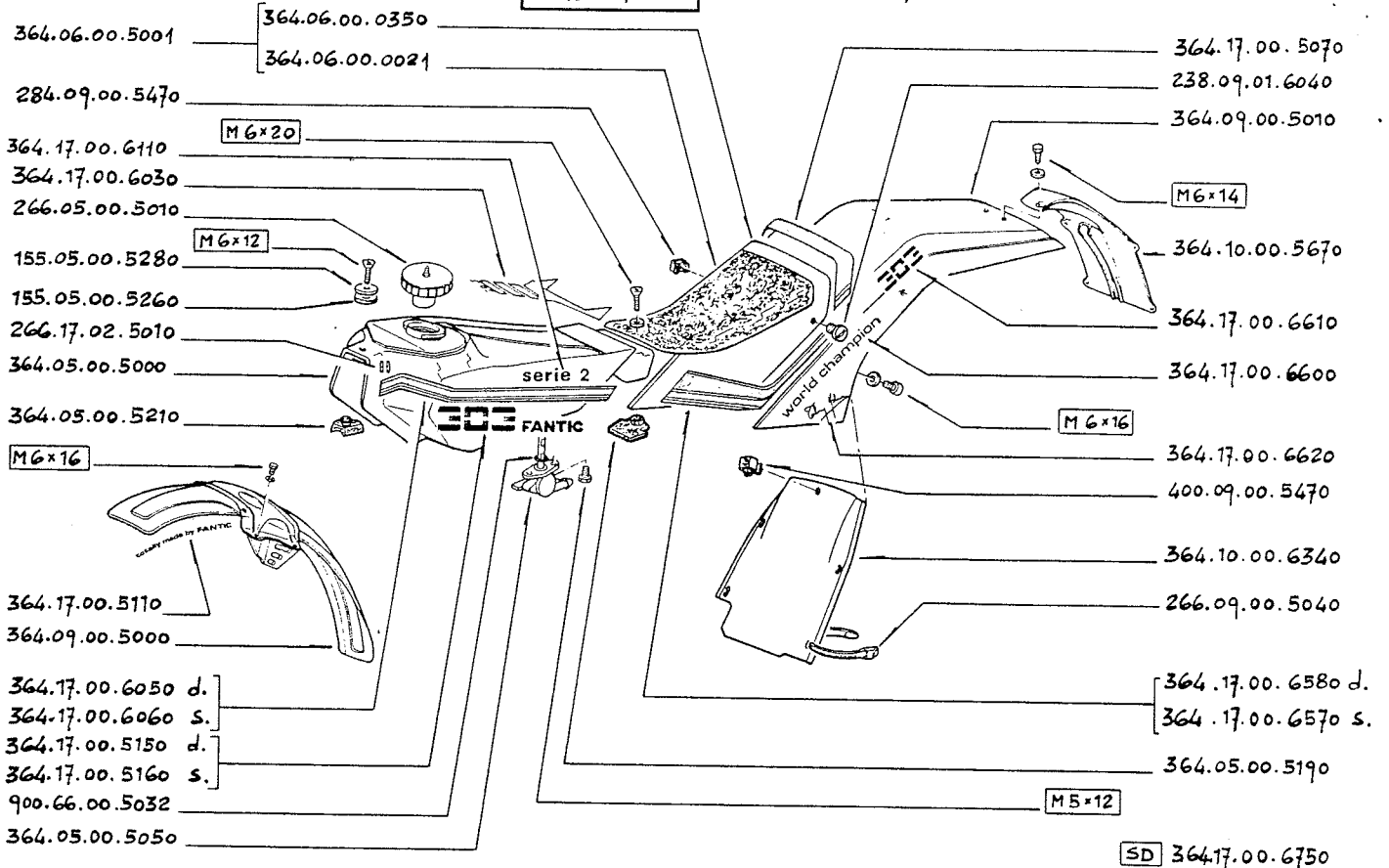

TRIAL 303

C14

10-1987		

colore GIALLO/BLU
color YELLOW/BLUE

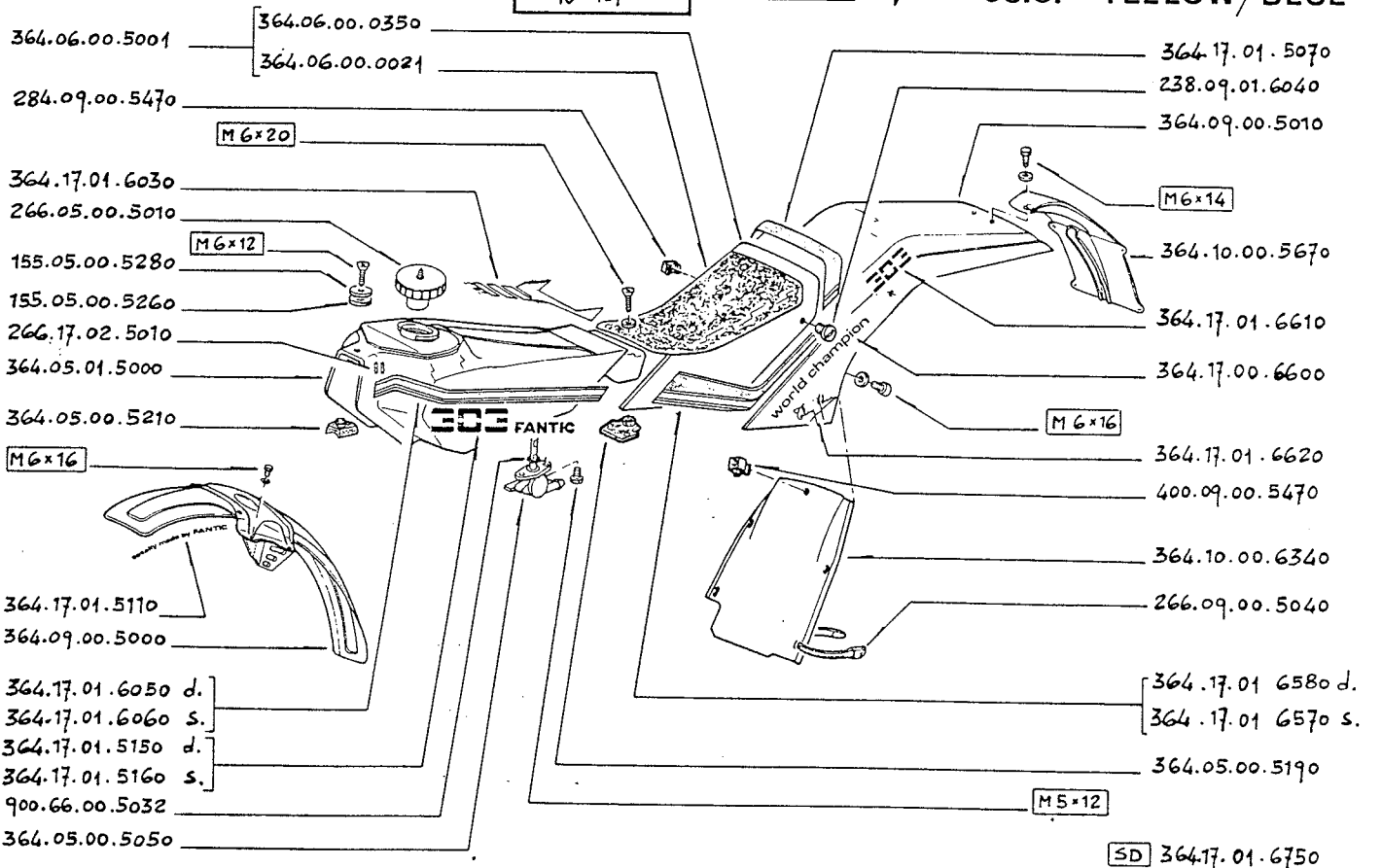

TRIAL 243

D1

D2		
10-1987		

colore ROSSO/BLU
color RED/BLUE

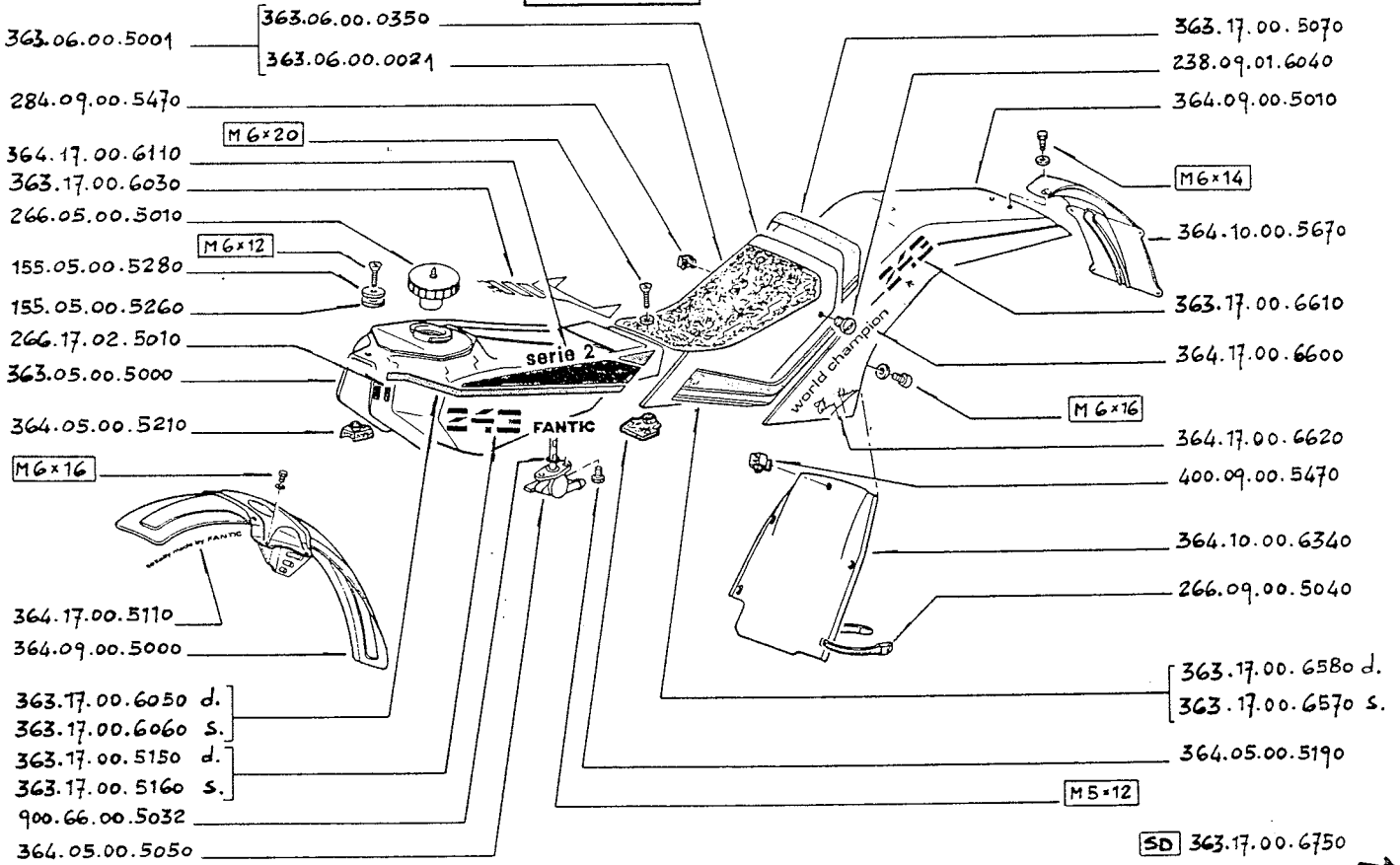

TRIAL 243

D2

10-1987		

colore GIALLO/BLU
color YELLOW/BLUE

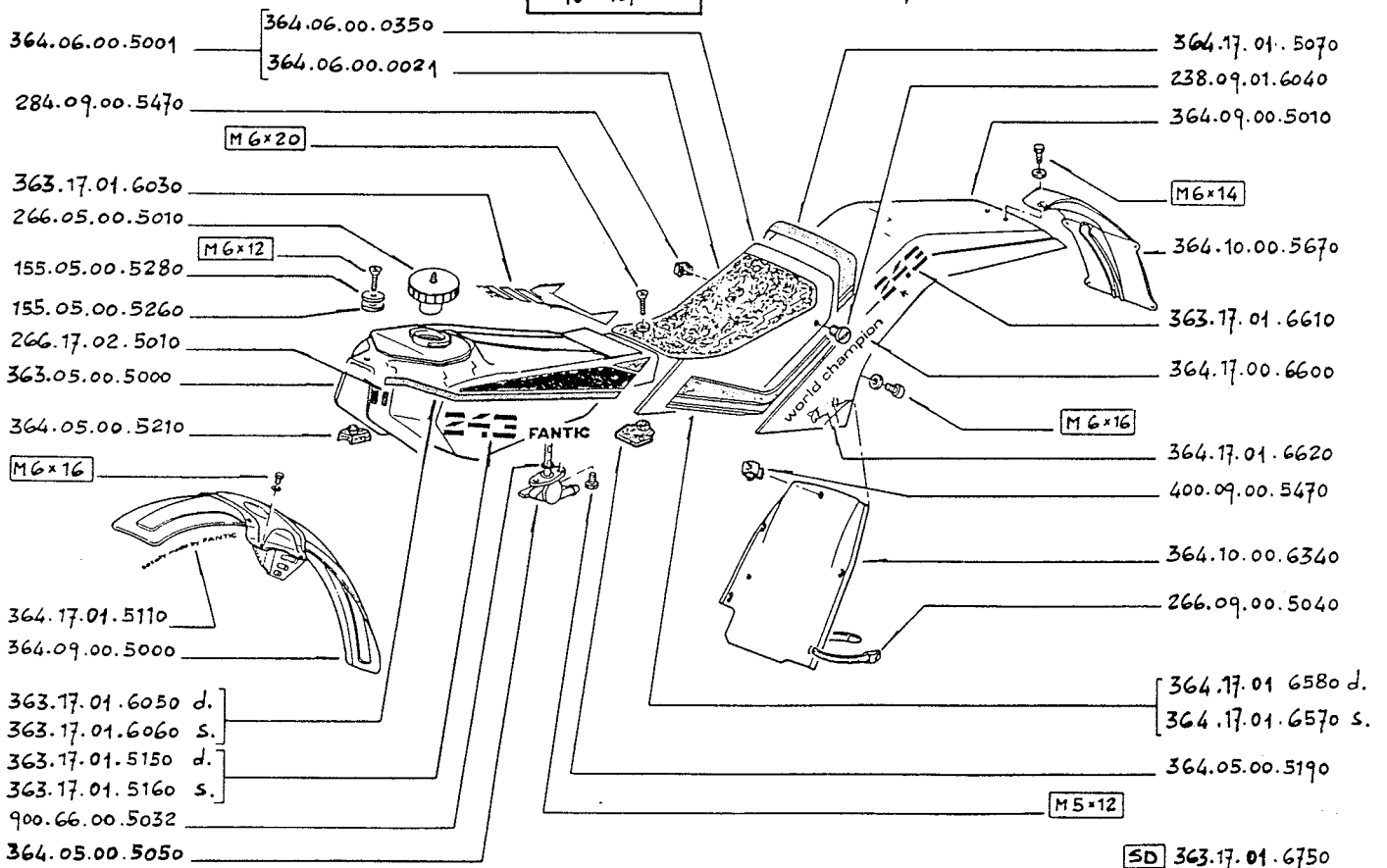

TRIAL 125

D5

D6		
10-1987		

colore ROSSO/BLU
color RED/BLUE

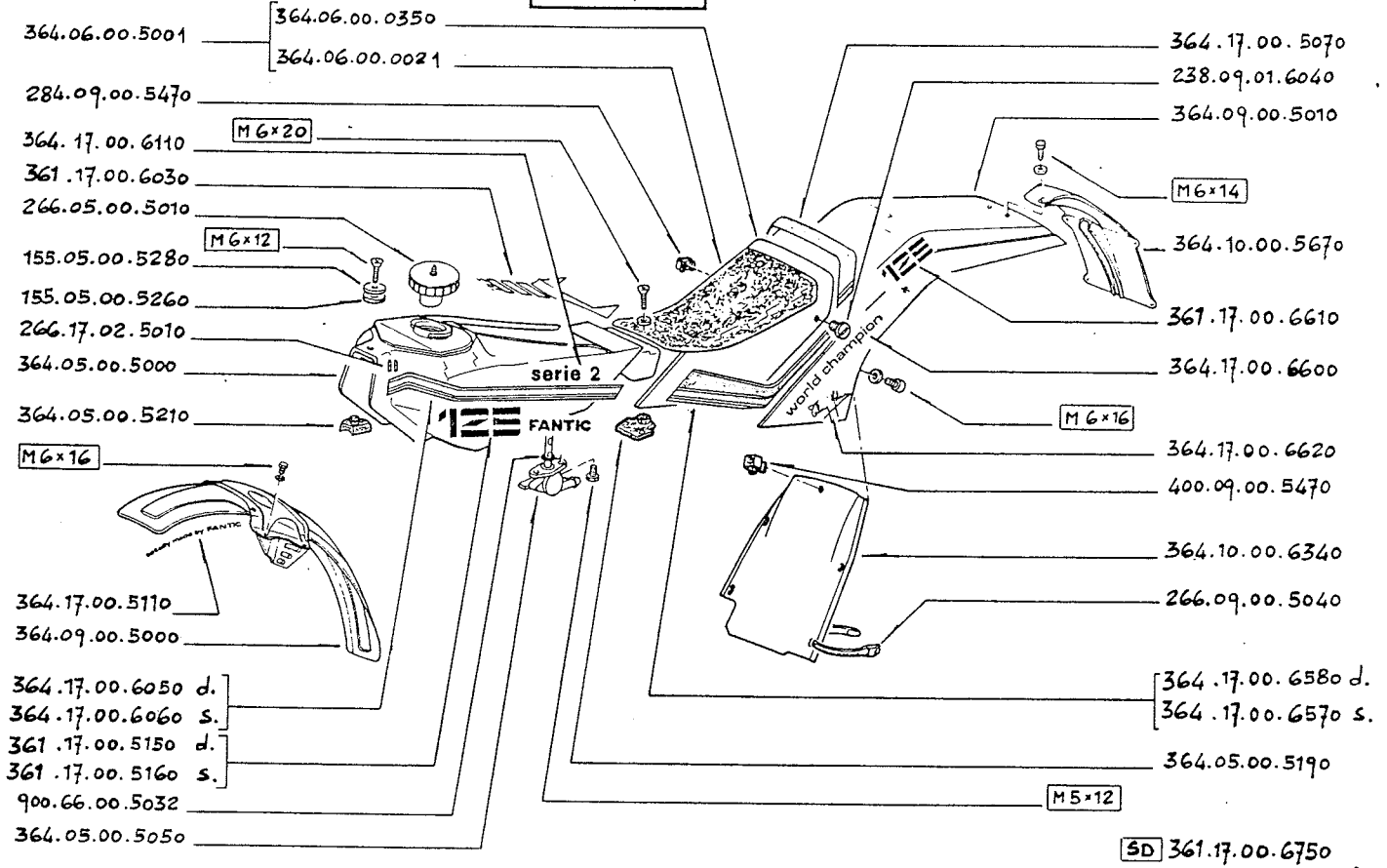

TRIAL 125

D6

10-1987		

colore GIALLO/BLU
color YELLOW/BLUE

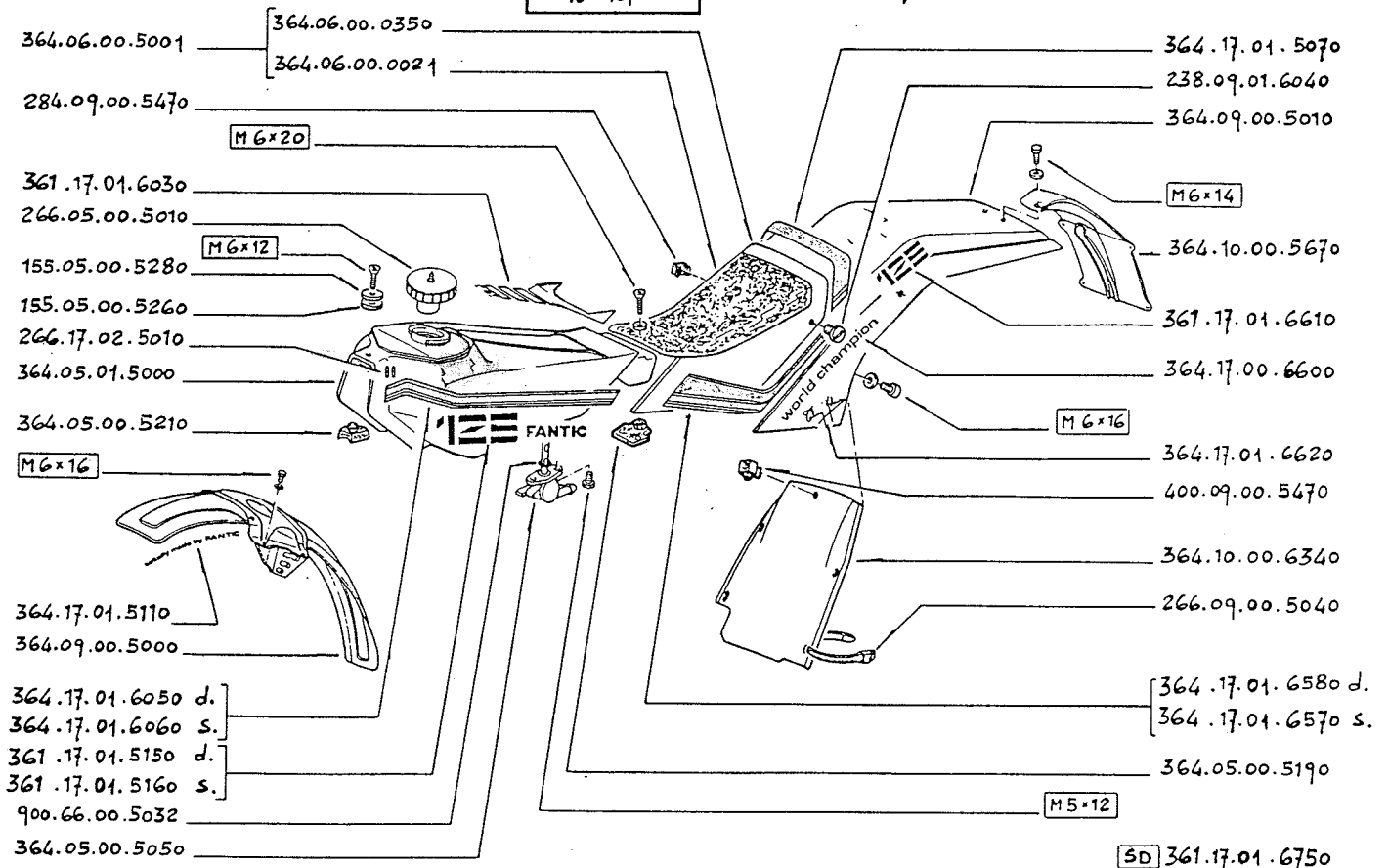

D9

D10	D11	
10-1987		

- Perno ruota in acciaio
- Steel wheel axle

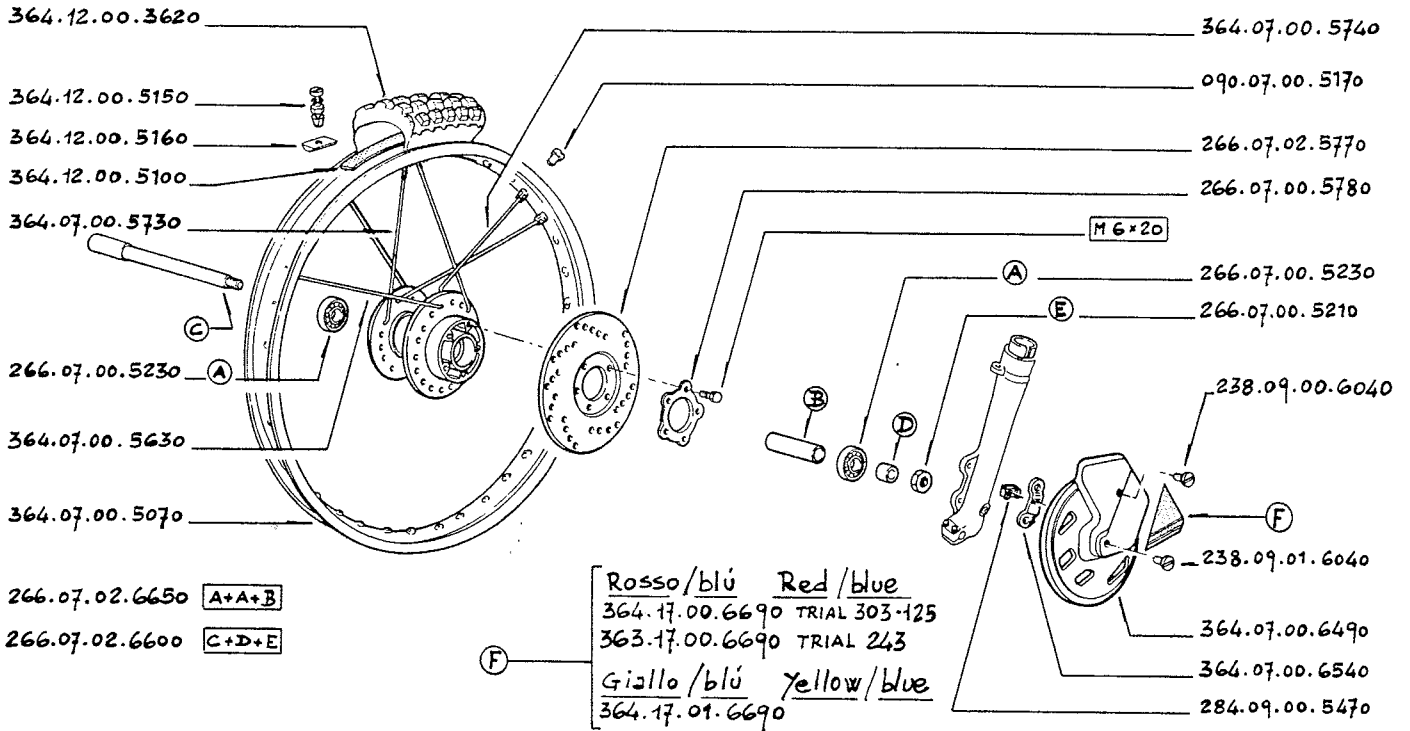
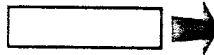

364.07.00.5000 Ruota anteriore completa
266.07.02.5061 Mozzo anteriore completo

- Roue avant complète
- Moyeu avant complète
- Front wheel complete
- Front hub complete
- Vorderrad Komplett
- Vorderradnabe Komplett

**serie 2****TRIAL 303-125****D10**

D11		
10-1987		

- Perno ruota in lega leggera
- Light alloy wheel axle

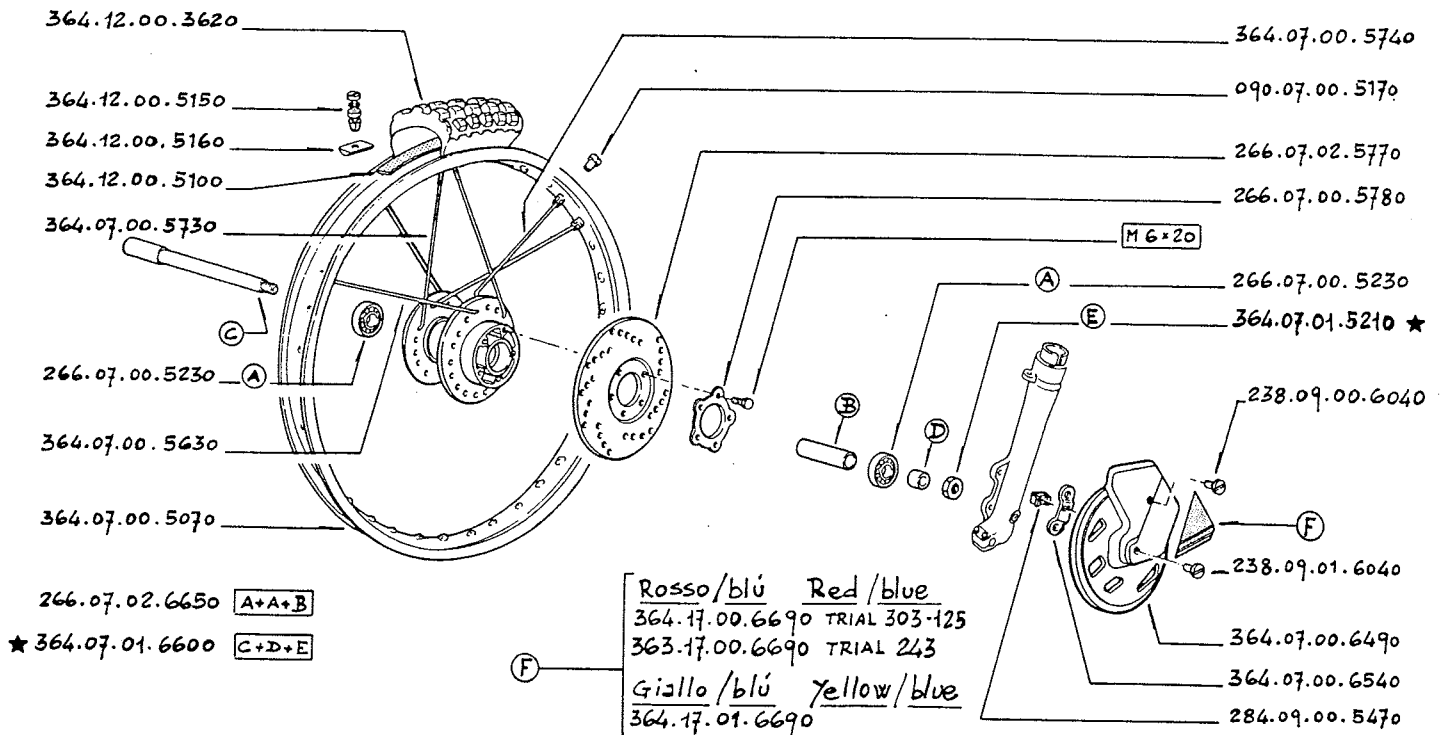
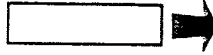

★ 364.07.01.5000 Ruota anteriore completa
★ 266.07.02.5062 Mozzo anteriore completo

- Roue avant complète
- Moyeu avant complète
- Front wheel complete
- Front hub complete
- Vorderrad Komplett
- Vorderradnabe Komplett



senza perno ruota | without wheel axle

serie 2
TRIAL 243

D11

10-1987		

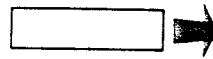

- Perno ruota in acciaio
- Steel wheel axle

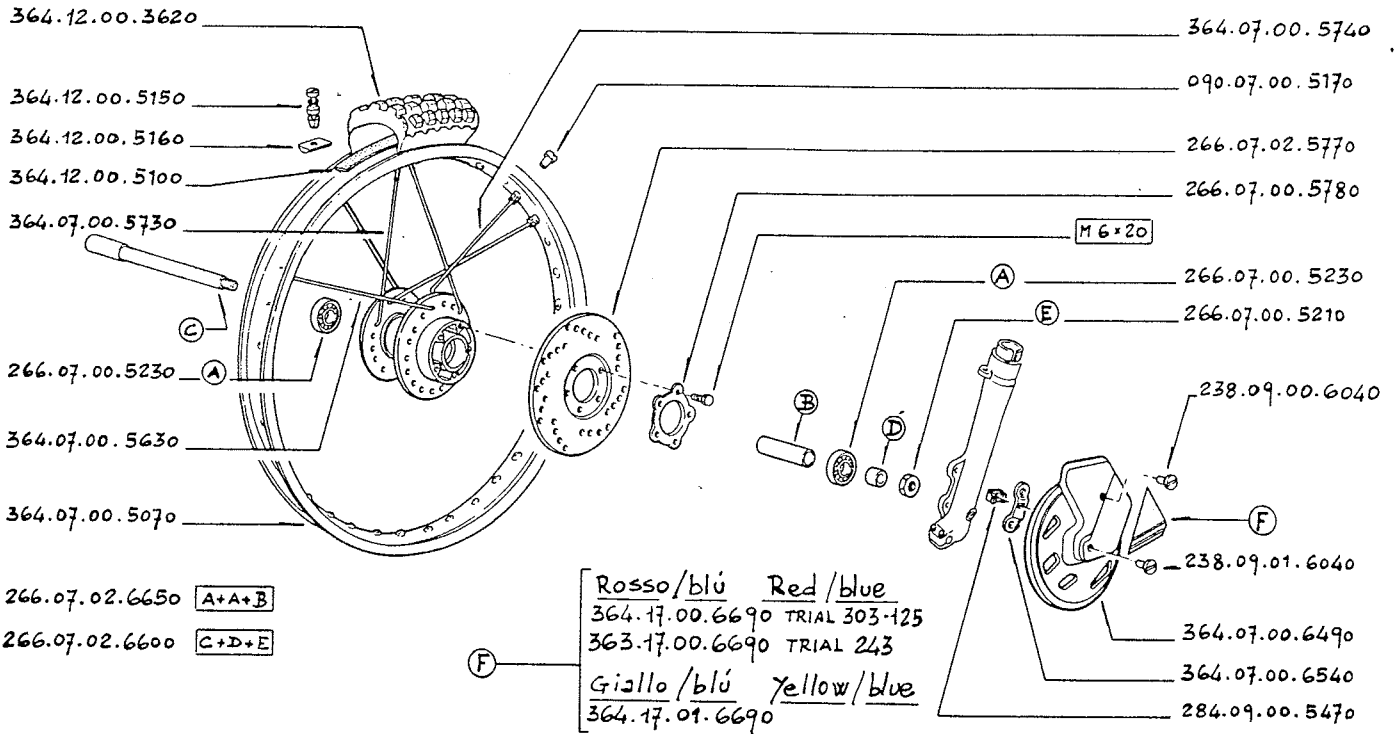

D13

D14	D15
10-1987	

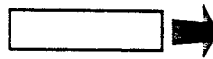

- Perno ruota in acciaio
- Steel wheel axle

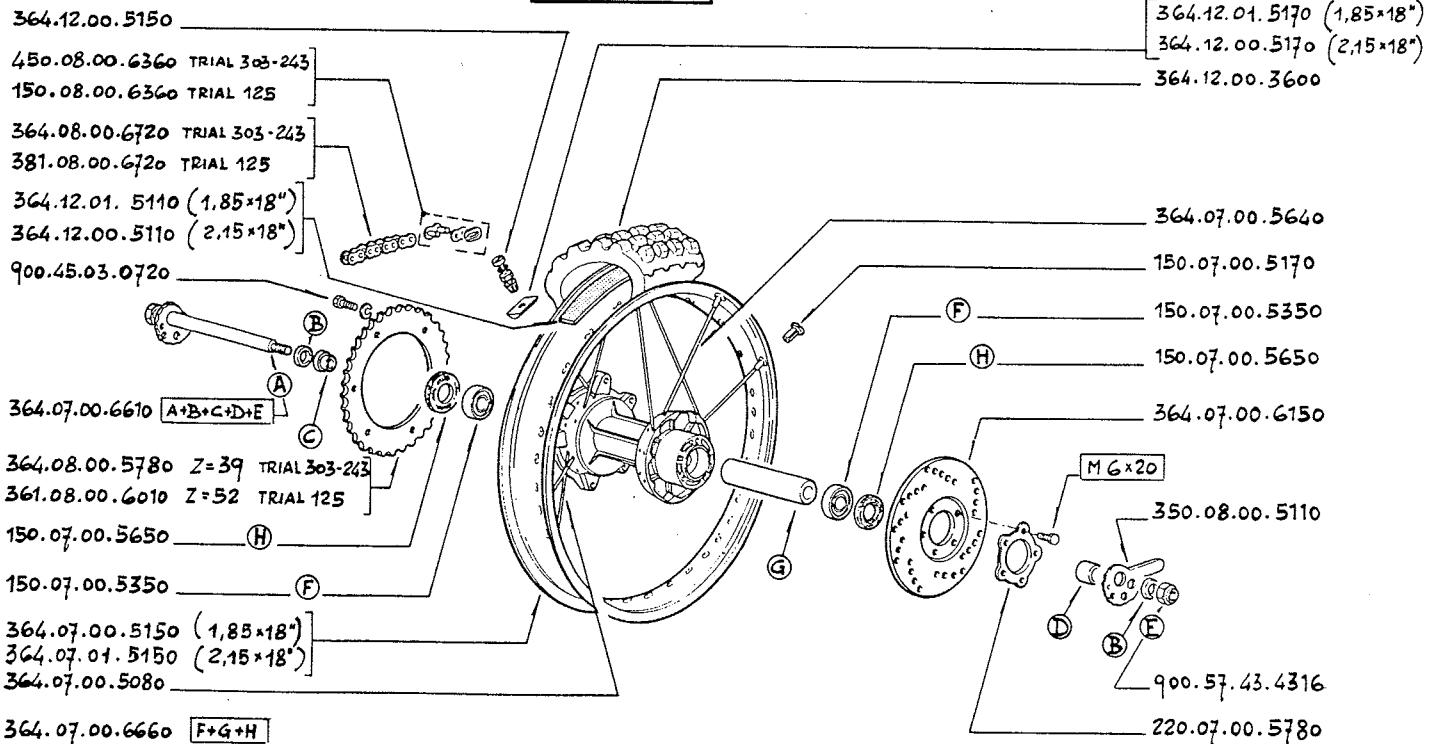

serie 2
TRIAL 303-125

D14

D15
10-1987

- Perno ruota in lega leggera
- Light alloy wheel axle
364.12.01.5170 (1,85x18")
364.12.00.5170 (2,15x18")

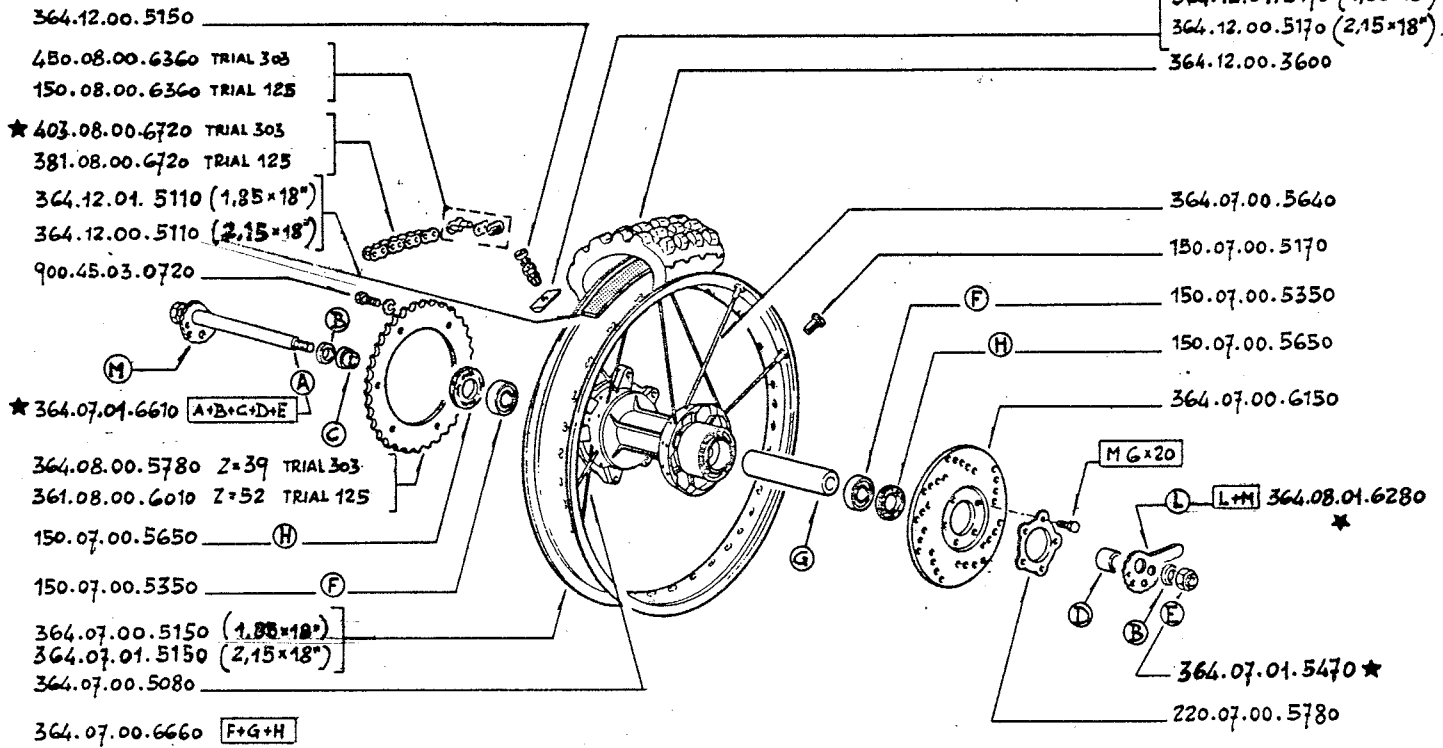

- ★ 364.07.01.5290 TRIAL 303
- ★ 361.07.01.5290 TRIAL 125
- ★ 364.07.00.5304 TRIAL 303
- ★ 361.07.00.5304 TRIAL 125

Ruota post. cpl. - Roue arriere complete - Rear wheel complete - Hinterrad Komplett

Mozzo post. cpl. - Moyeu arrier complet - Rear hub complete - Hinterradnabe Komplett

senza perno ruota | without wheel axle

serie 2
TRIAL 243

D15

D15
10-1987

- Perno ruota in acciaio
- Steel wheel axle
364.12.01.5170 (1,85x18")
364.12.00.5170 (2,15x18")

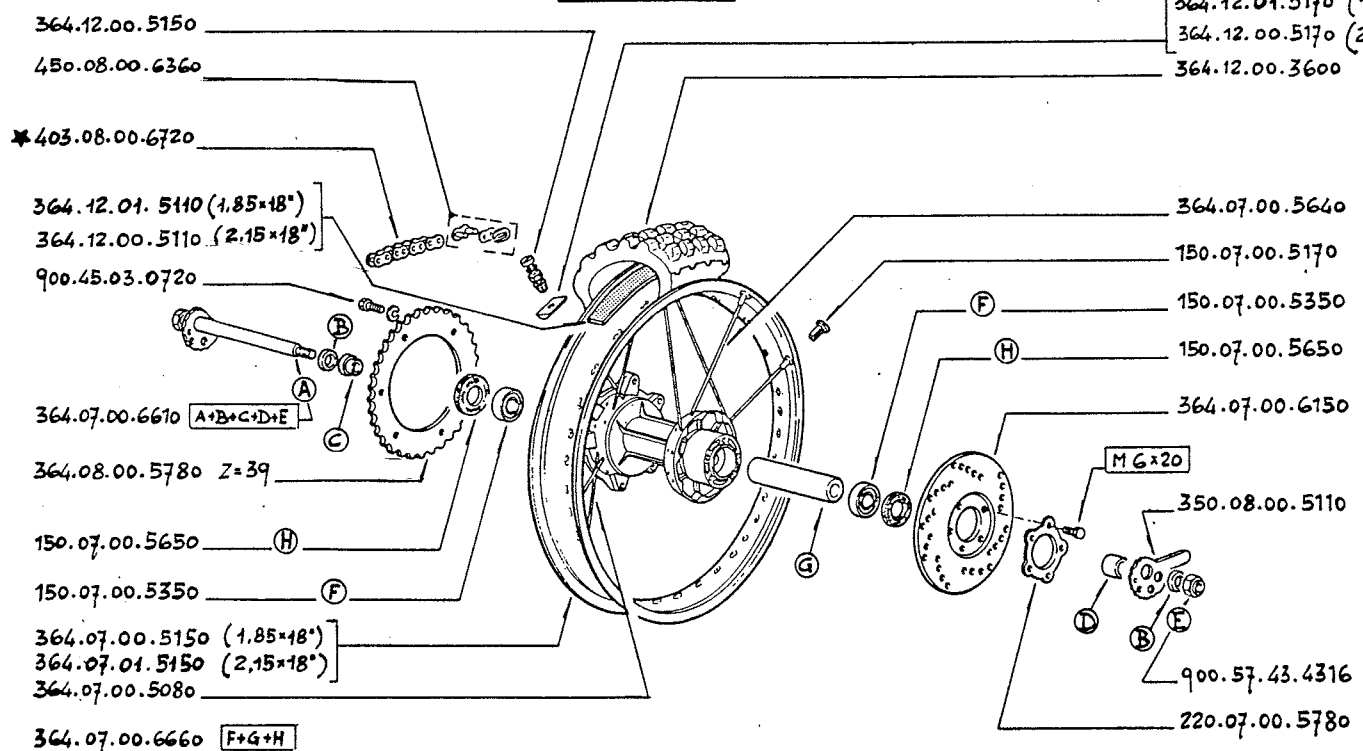

364.07.00.5290

Ruota post. cpl. - Roue arriere complete - Rear wheel complete - Hinterrad Komplett

364.07.00.5300

Mozzo post. cpl. - Moyeu arrier complet - Rear hub complete - Hinterradnabe Komplett

E1

10-1987

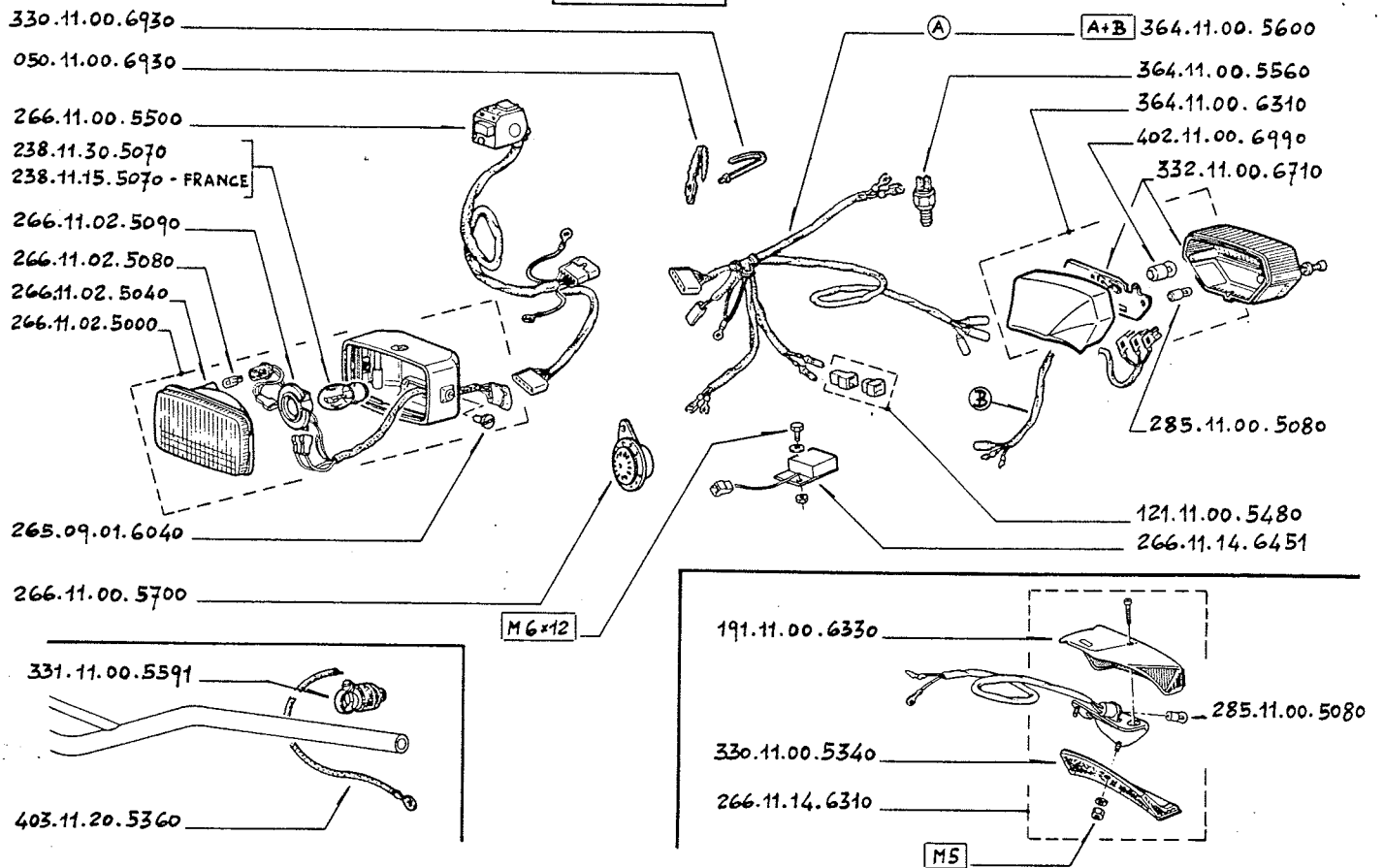
**E5**

10-1987

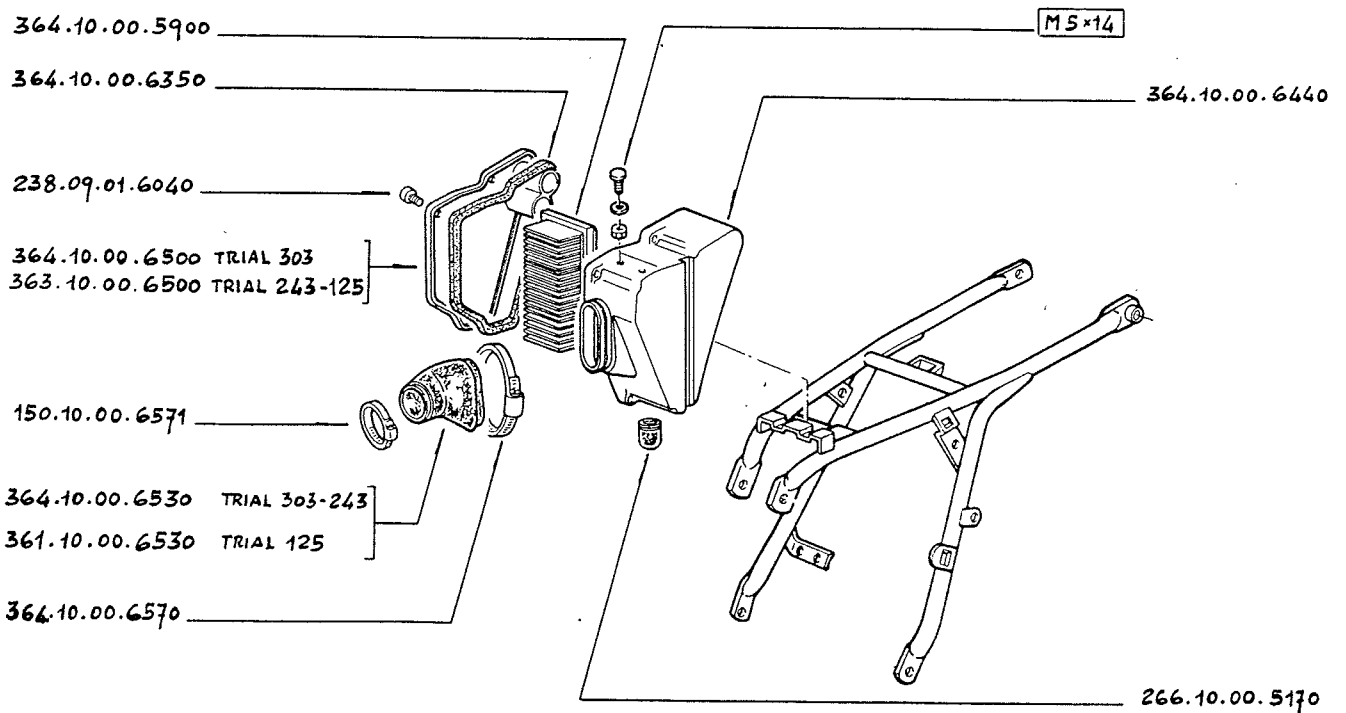

E9

10-1987

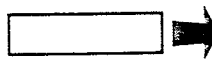

364.13.00.5320 TRIAL 303
363.13.00.5320 TRIAL 243-125

150.13.00.5071

403.13.00.5140 TRIAL 303
250.13.00.5140 TRIAL 243-125

364.13.00.5370

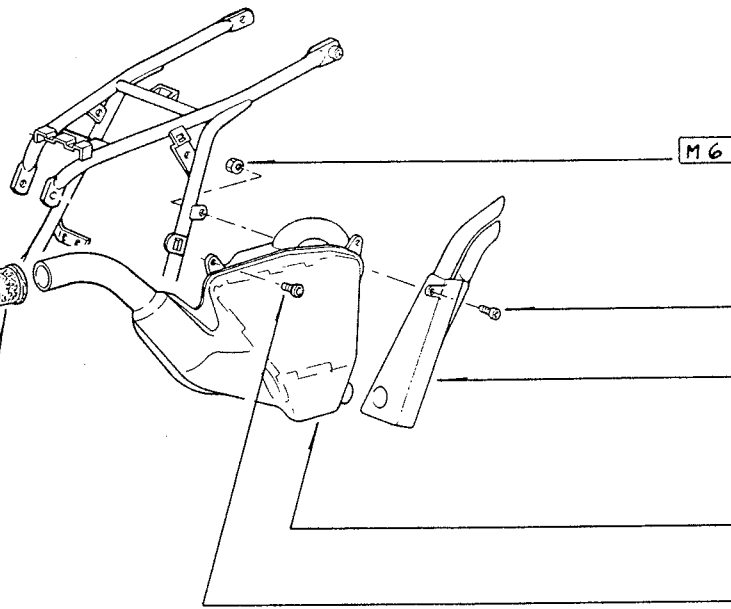

E13

10-1987

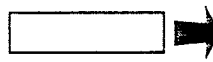

266.16.00.5600

330.16.00.6160

364.16.00.7080

M6x16

238.16.00.5050

266.16.00.5150

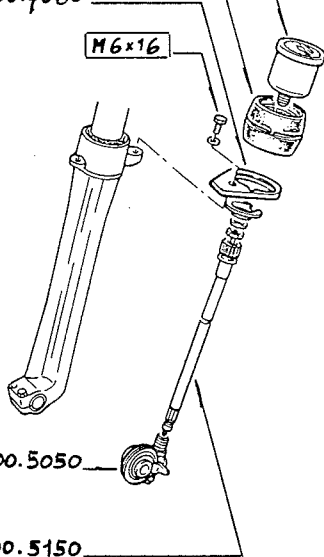

350.11.00.6930

266.16.21.5400

900.23.24.0612

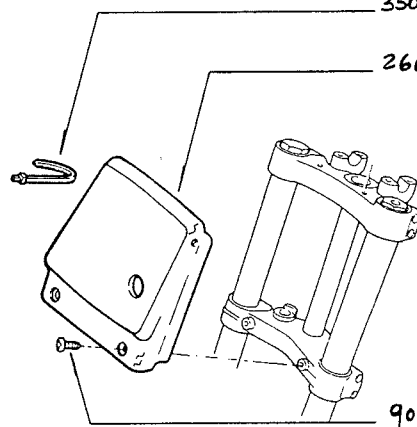

266.15.00.5180

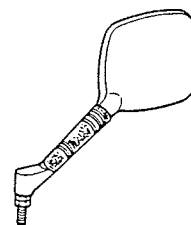

F1

10-1987		

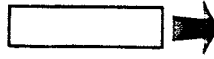

364.40.00.5000 TRIAL 303
 364.40.15.5000 TRIAL 303 FRANCE
 363.40.15.5000 TRIAL 243
 361.40.00.5000 TRIAL 125

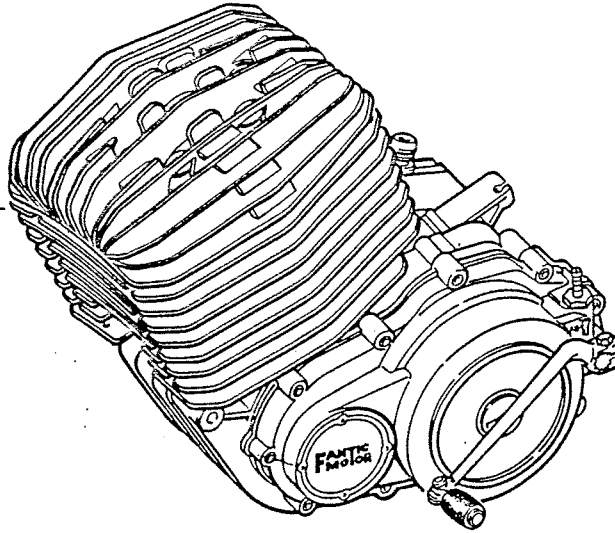
**TRIAL 303**

238.41.00.6340
 900.25.10.0635

F5

F6	F7
10-1987	

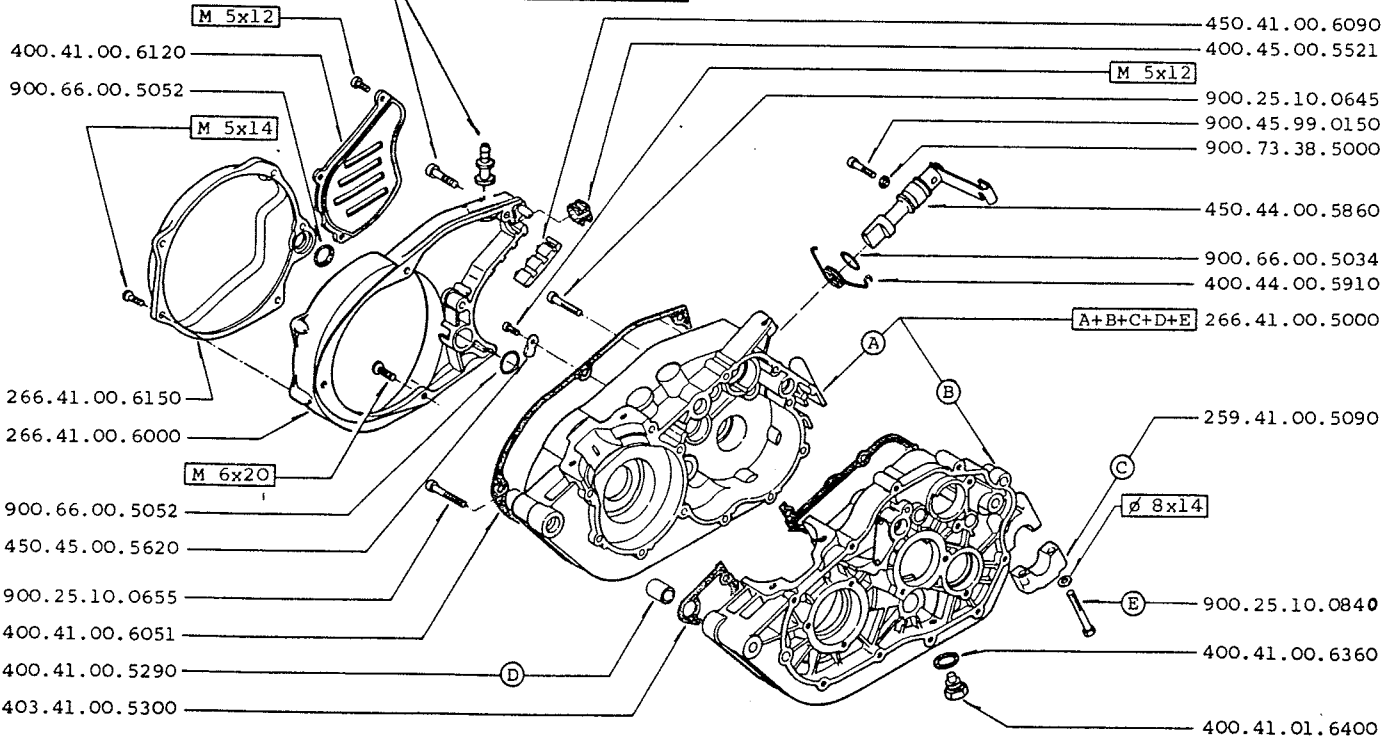
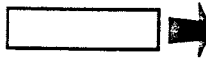

SG 266.41.00.6250



TRIAL 243

F6

F7		
10-1987		

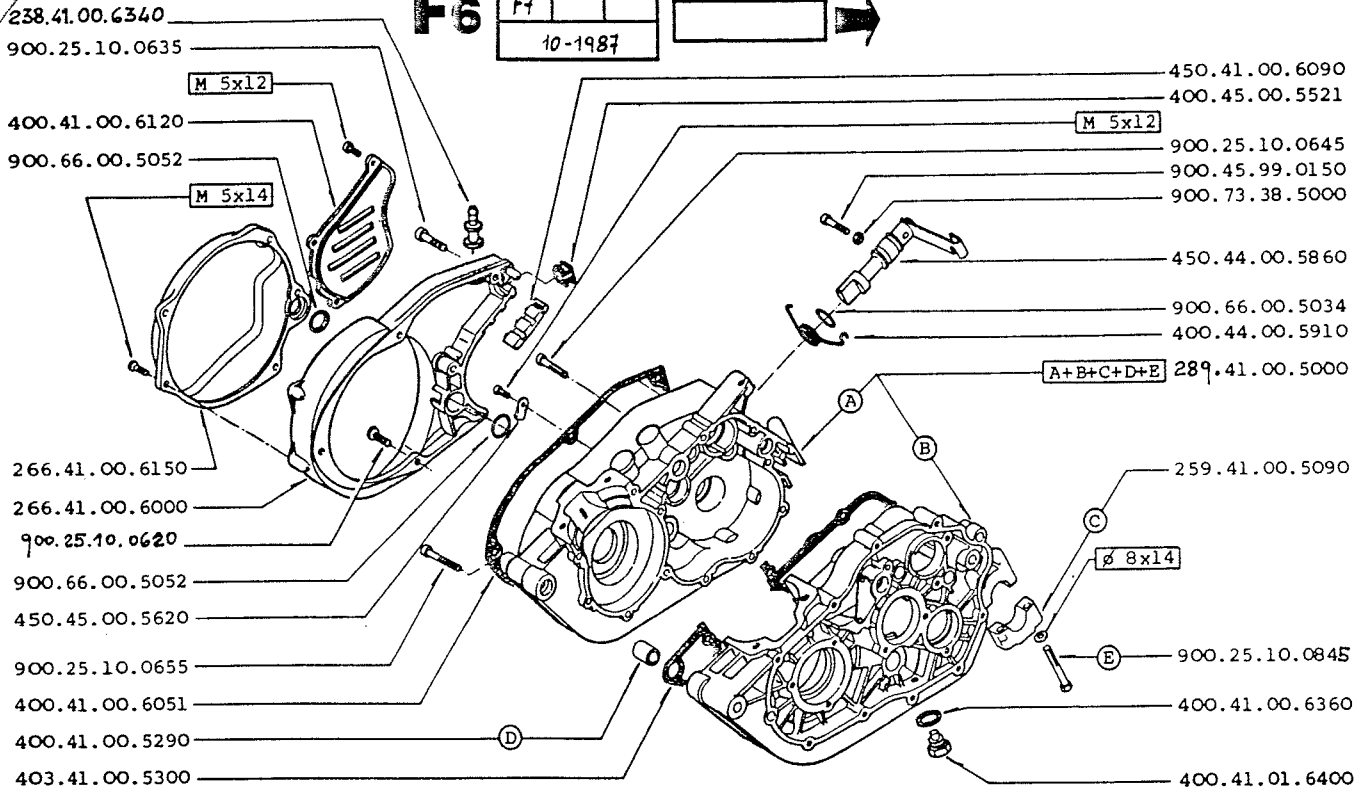
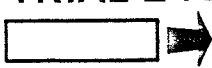

SG 289.41.00.6250



TRIAL 125

F7

10-1987		

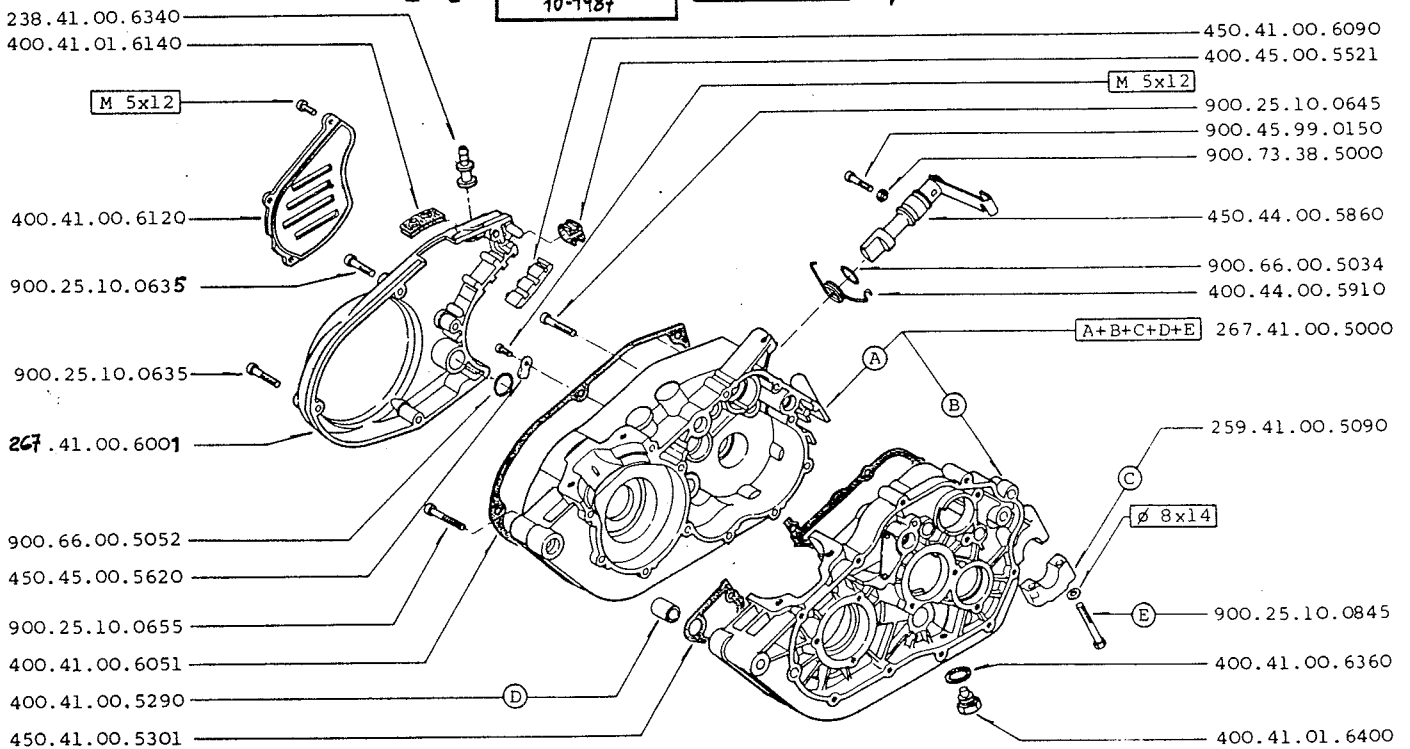
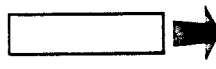

SG 267.41.00.6250

F9

10-1987		

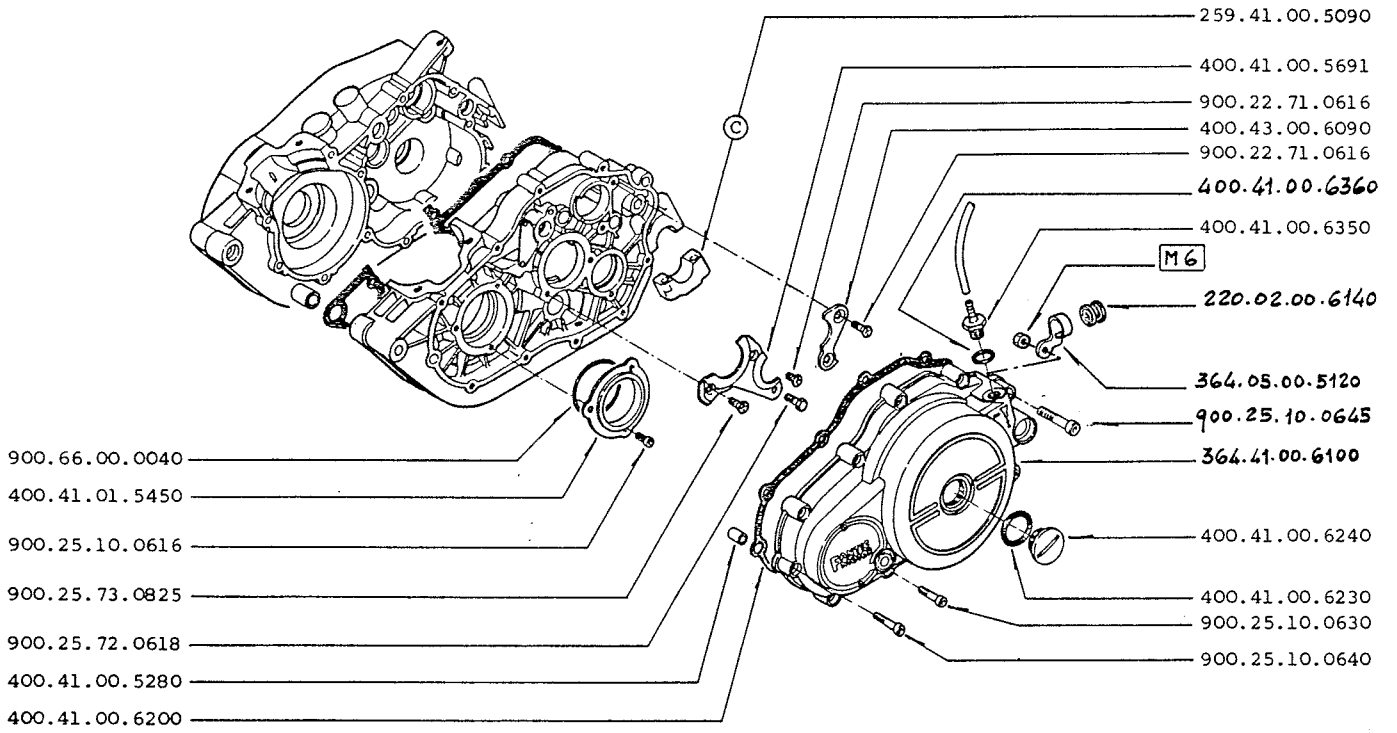
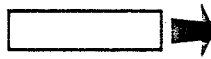

TRIAL 303

F13

F14	F15
10-1987	

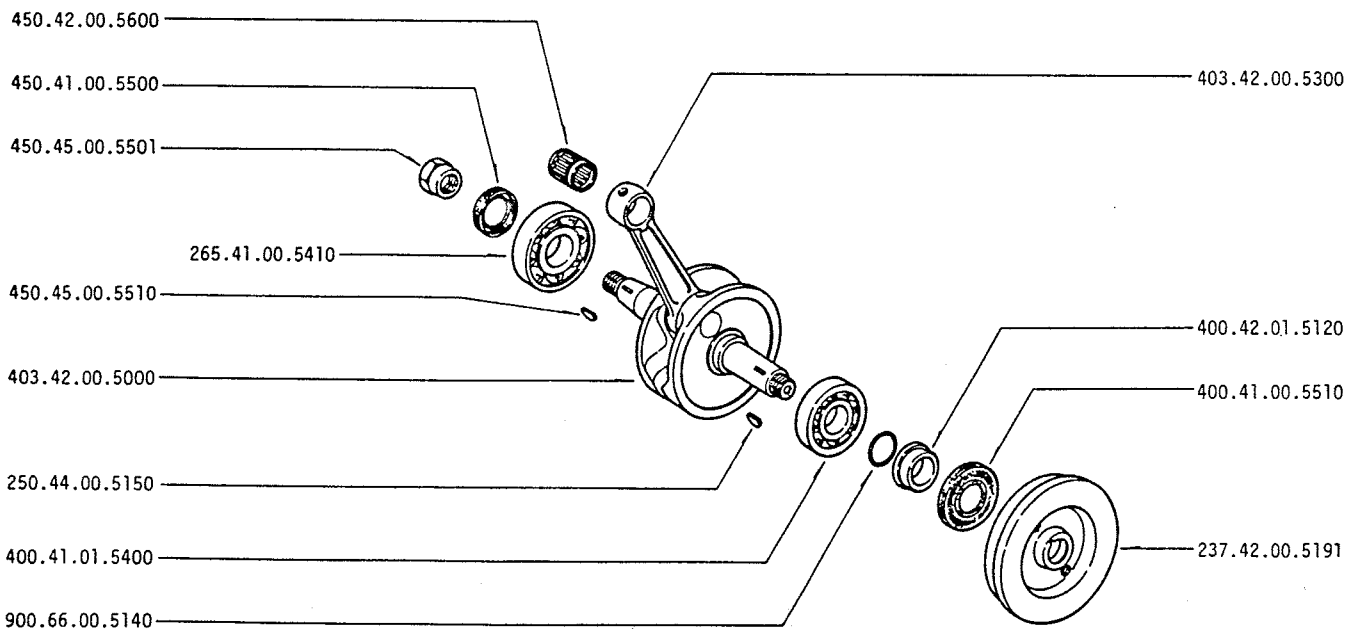
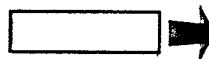

SP 450.41.00.6260



TRIAL 243

F14

F15		
10-1987		

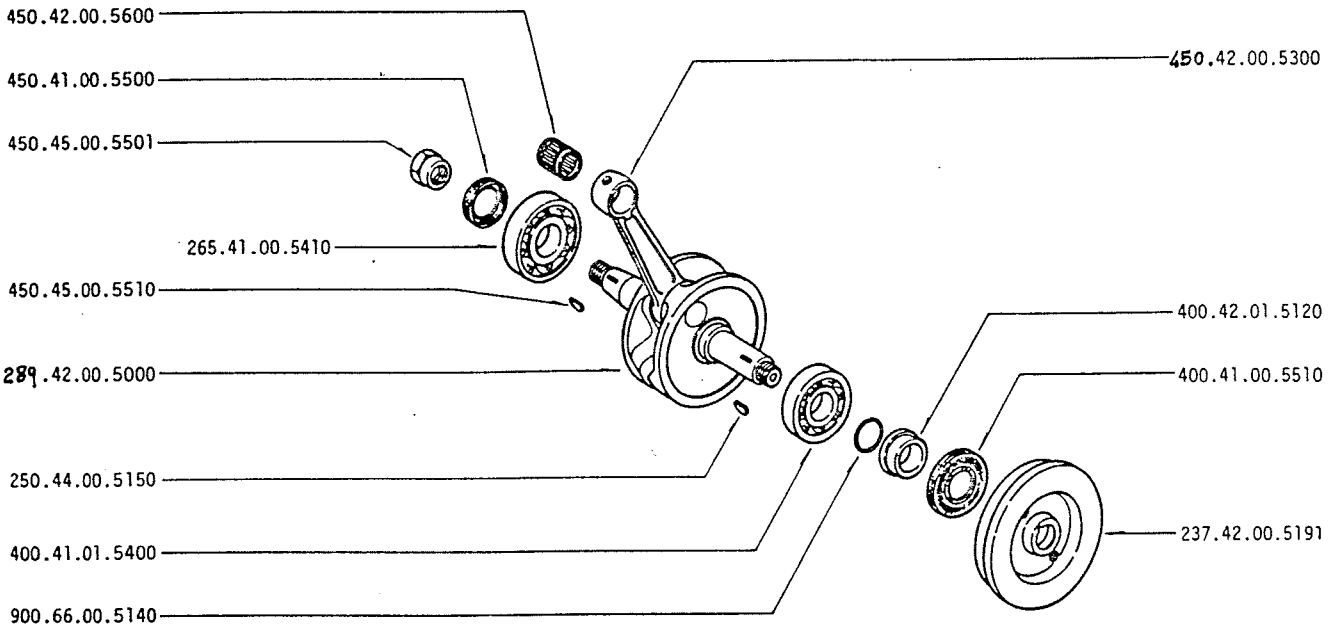
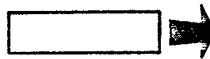

SP 450.41.00.6260



TRIAL 125

F15

10-1987		

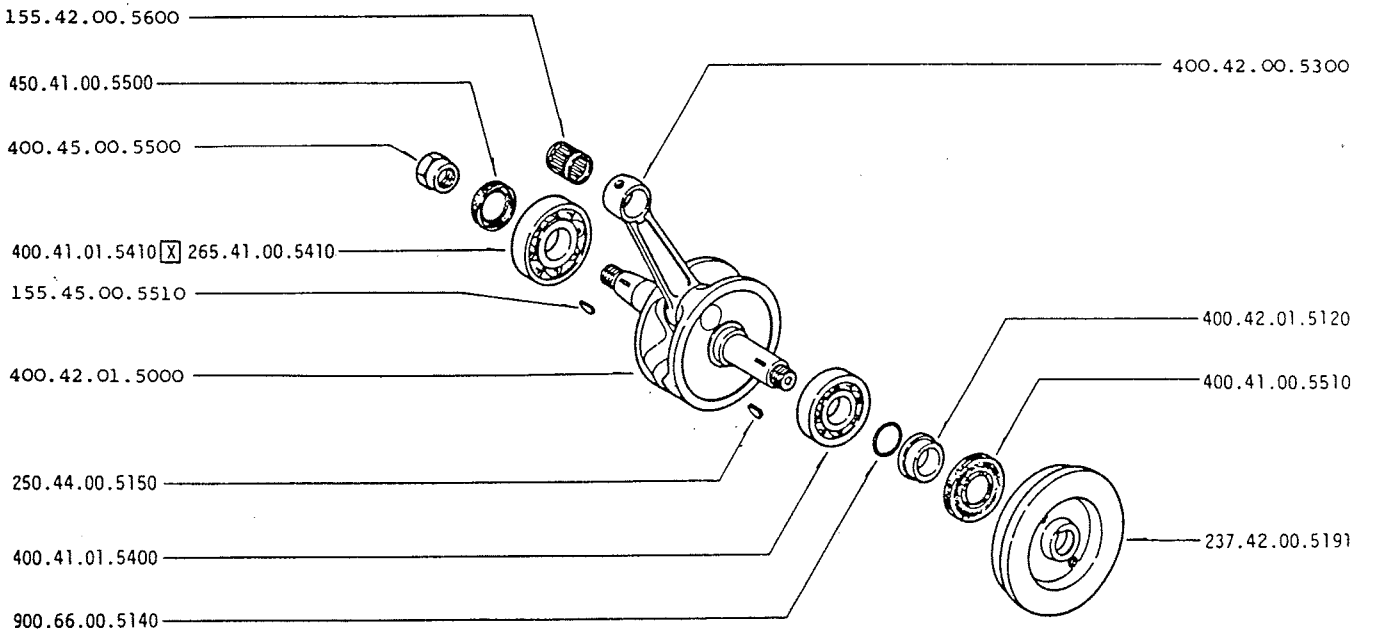
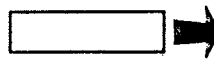

SP 450.41.00.6260

TRIAL 303

364.47.00.5990

G1

G2	G3
10-1987	

364.47.00.5800

403.47.00.5750

403.47.00.5001

403.47.15.5001 - FRANCE

403.47.00.6140

403.47.00.5700

403.47.00.5900

403.47.00.5910

450.48.00.5060

364.48.00.5050

403.48.00.5100

160.10.00.6570

FRANCE 403.47.00.5400
FRANCE 403.47.15.5400

FRANCE 403.47.00.5500
FRANCE 403.47.15.5500

FRANCE 403.47.00.5200
FRANCE 403.47.15.5200

E 403.47.00.5600

F 450.47.00.5650

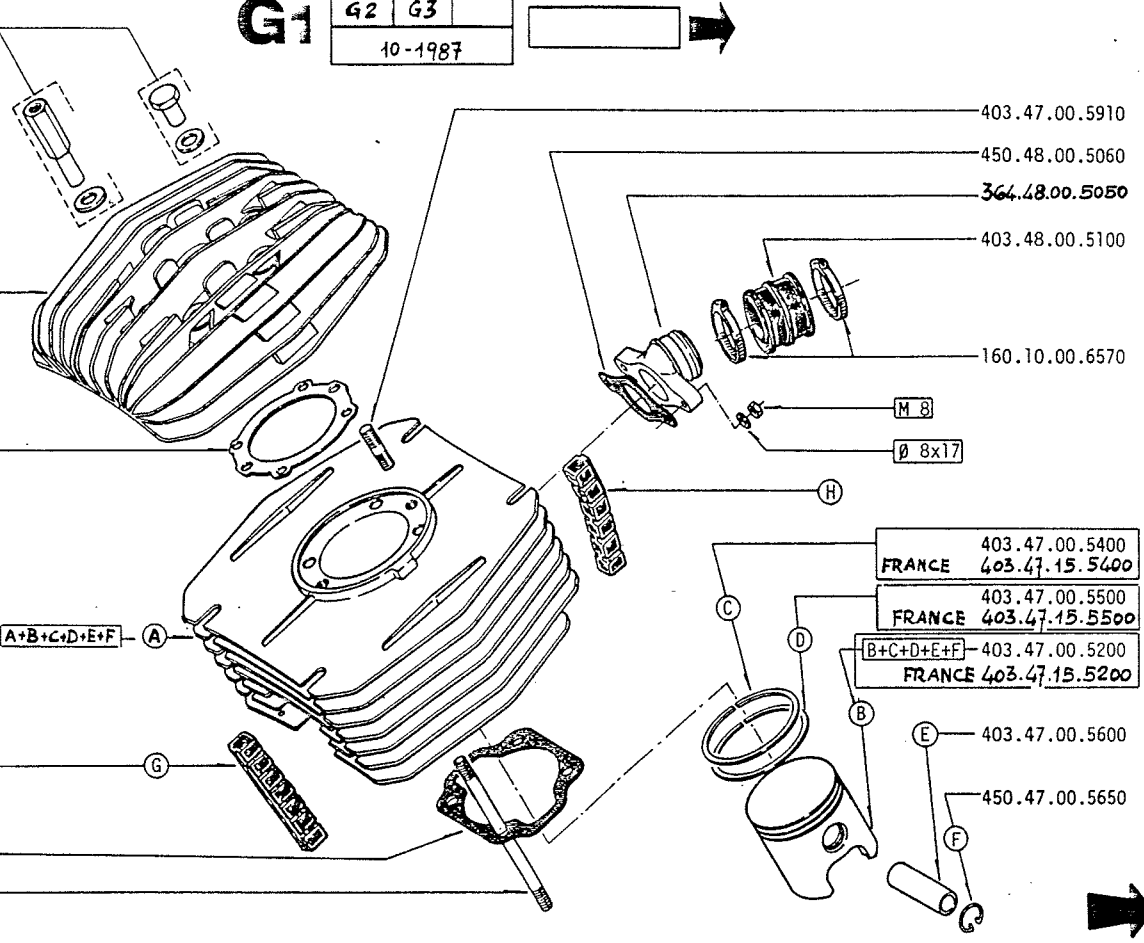

TRIAL 243

G2

G3
10-1987

363.47.00.5990

363.47.00.5800

450.47.00.5750

F+G+H 450.47.00.6140

450.47.00.5400

B+C+D+E 450.47.00.5200

450.47.00.5600

450.47.00.5650

160.10.00.6570

364.48.00.5050

450.48.00.5060

ø 8x14

M 8

403.48.00.5100

H

A A+B+C+D+E 289.47.00.5000

450.47.00.5700

450.47.00.5900

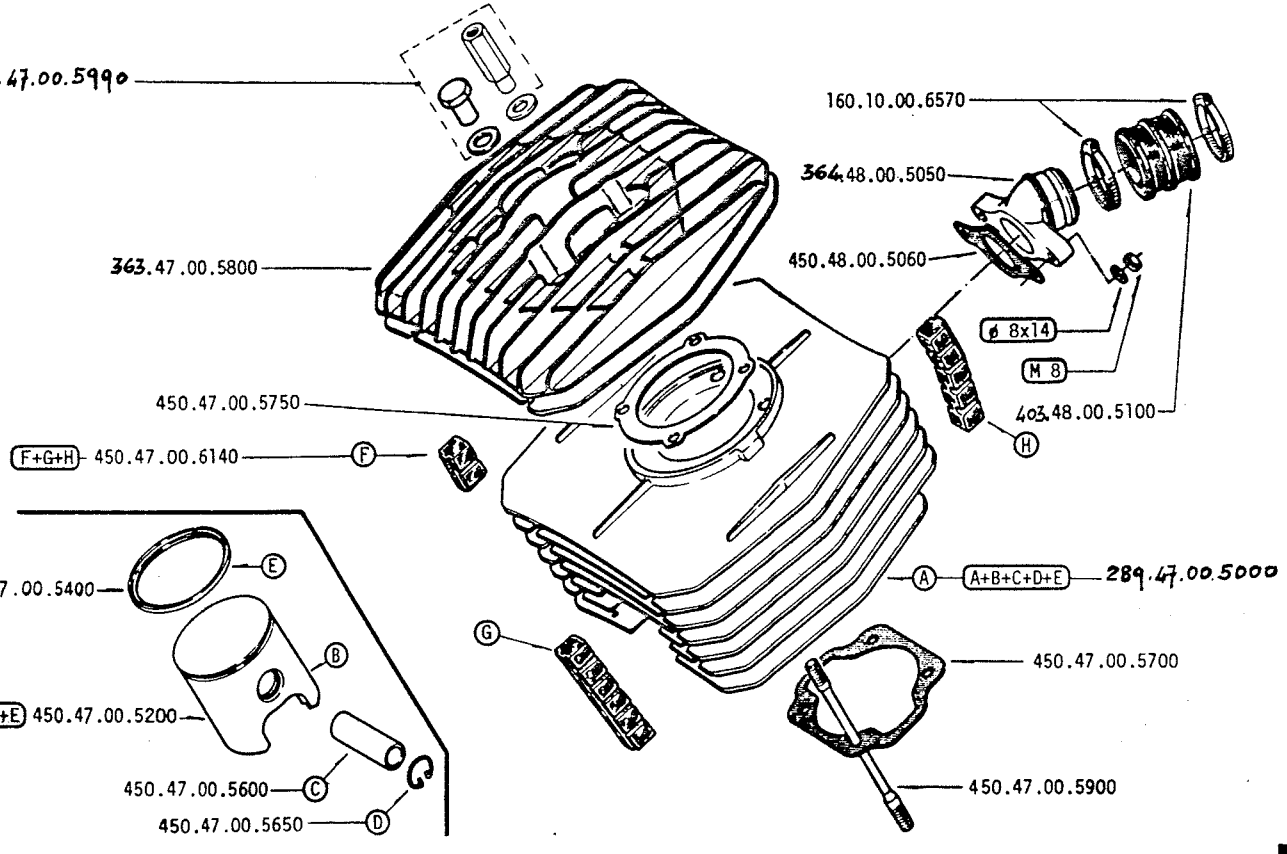

TRIAL 125

G3

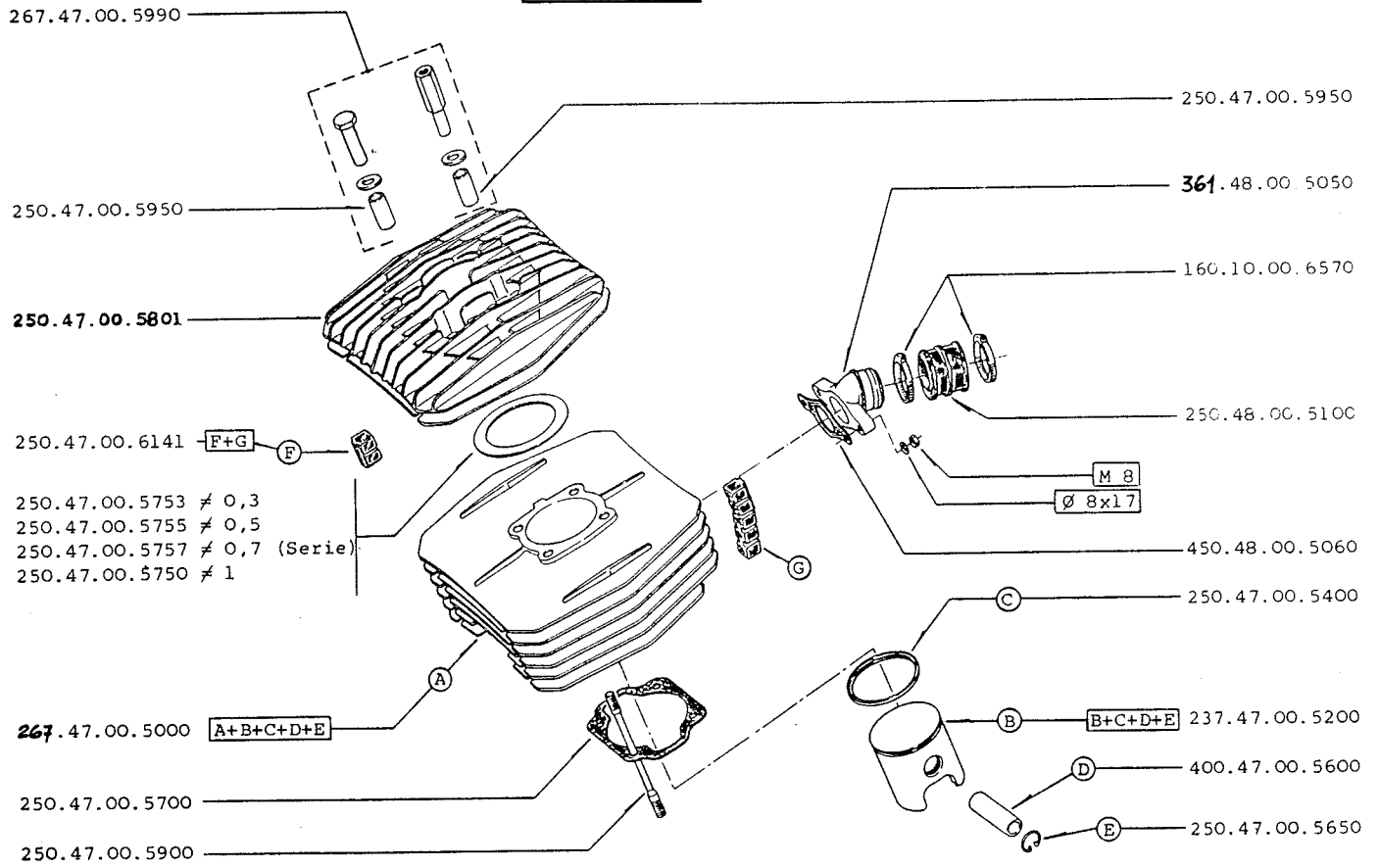
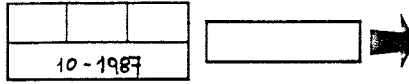

G5

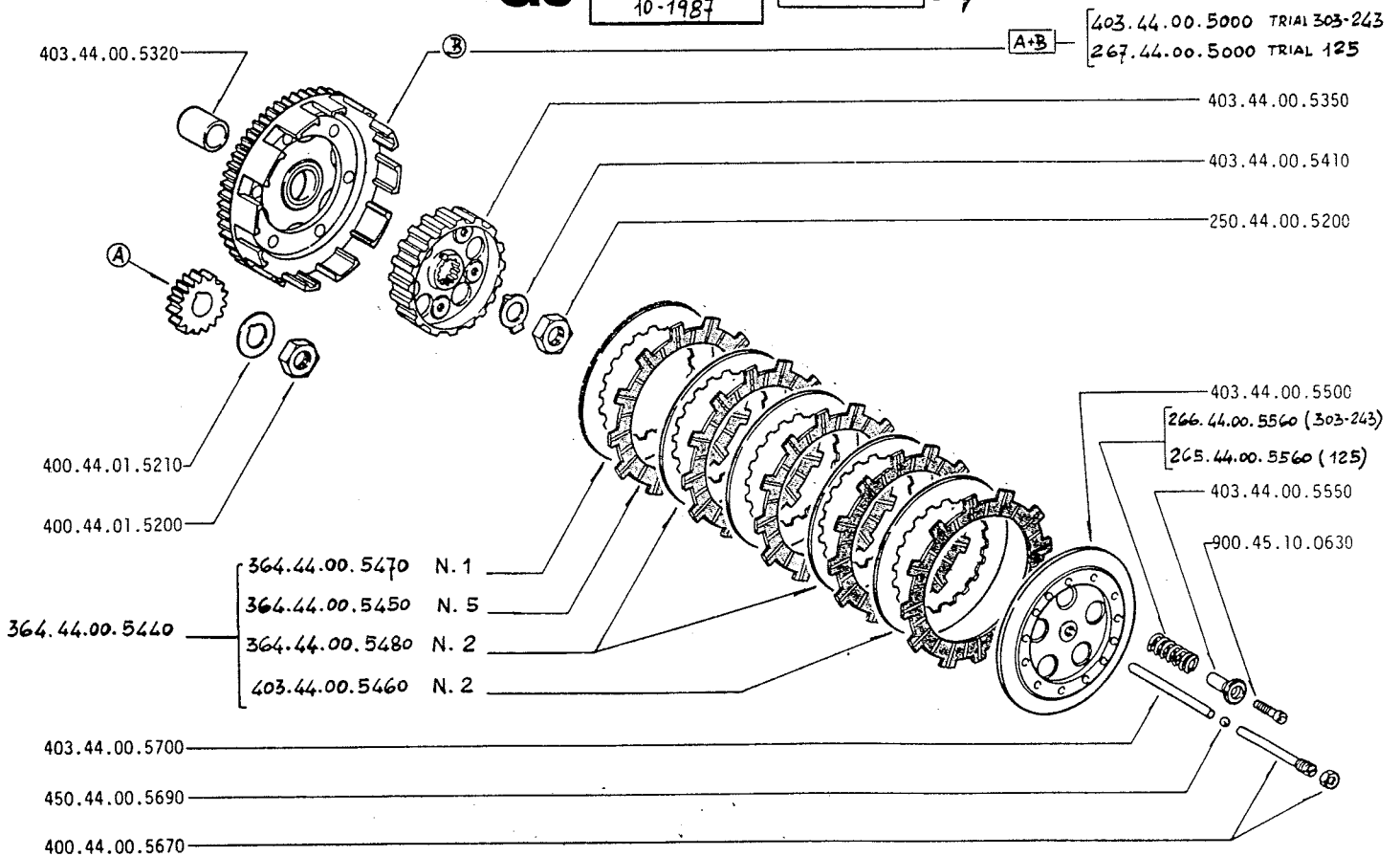

TRIAL 303

G9

G10	G11	
10-1987		



400.43.00.7110 Z=11
 400.43.00.7120 Z=12
 400.43.00.7130 Z=13

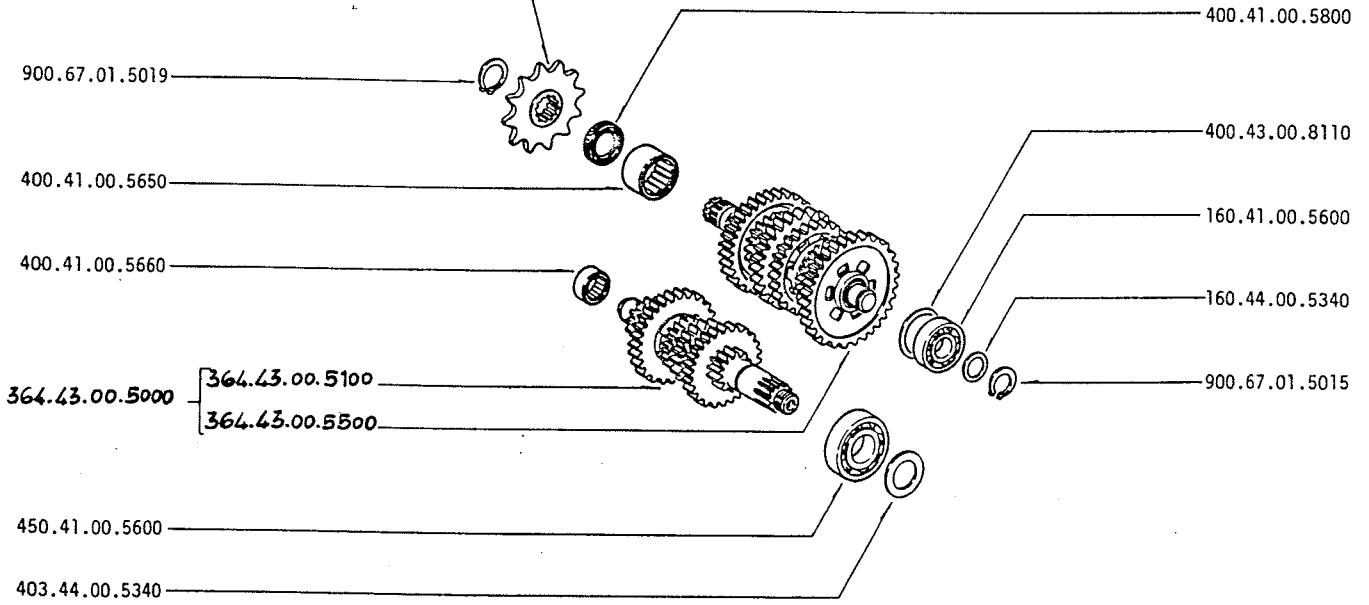

TRIAL 243

G10

G11		
10-1987		



400.43.00.7110 Z=11
 400.43.00.7120 Z=12
 400.43.00.7130 Z=13

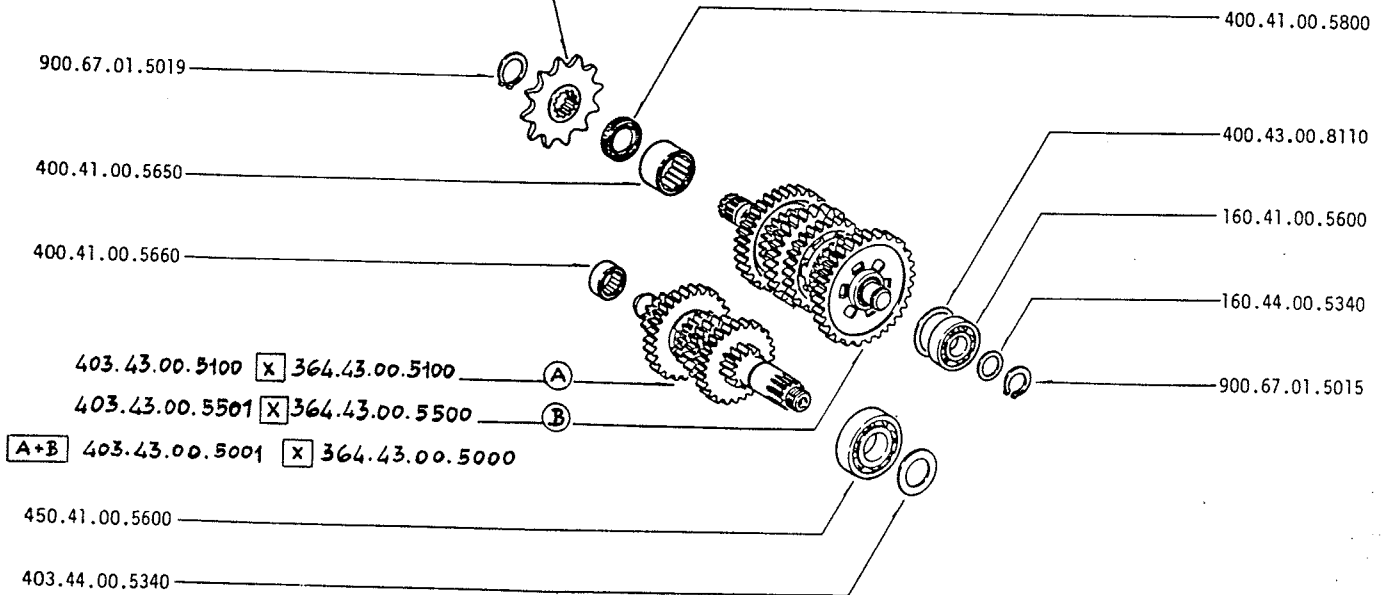

TRIAL 125

G11

10-1987		

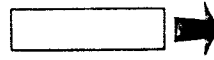

400.43.01.7120 Z=12
 400.43.01.7130 Z=13
 400.43.01.7140 Z=14

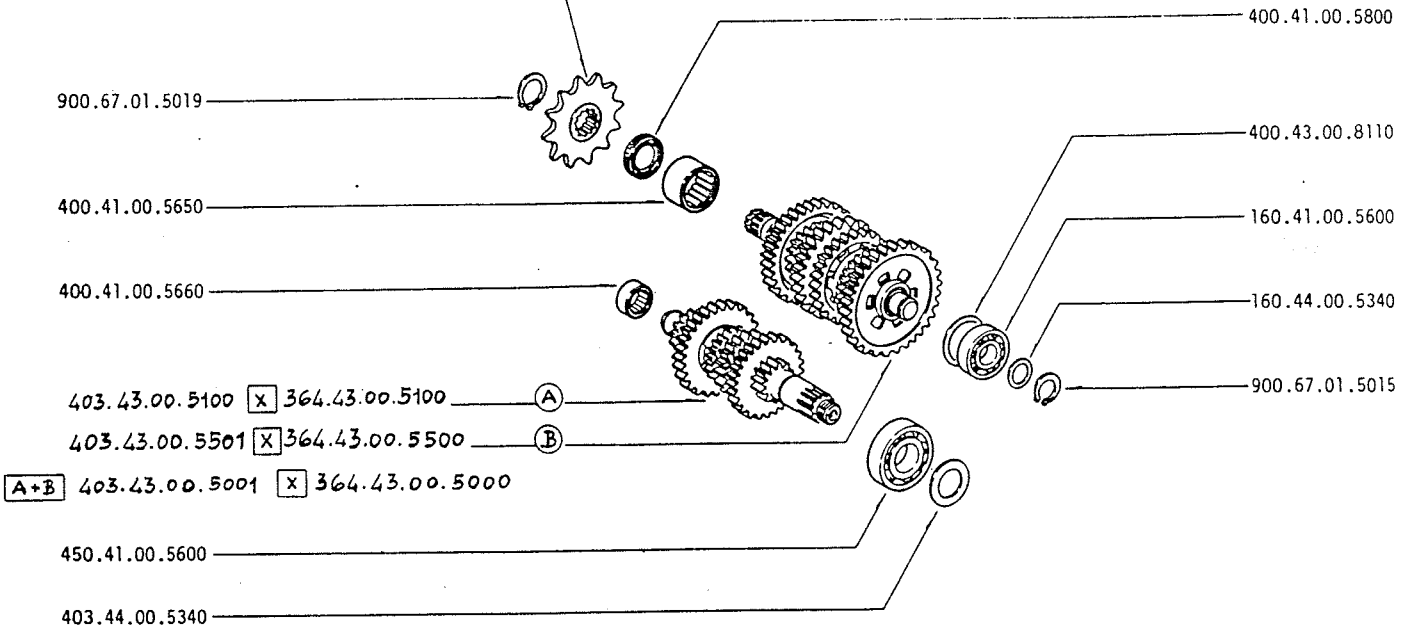

TRIAL 303

G13

G13		
10-1987		

